

INTERLIFT

BY PALFINGER

OWNER'S MANUAL

PTV 35, 3500 lbs. Capacity

PTV 44, 4400 lbs. Capacity

PTV 55, 5500 lbs. Capacity

PTV 66, 6600 lbs. Capacity

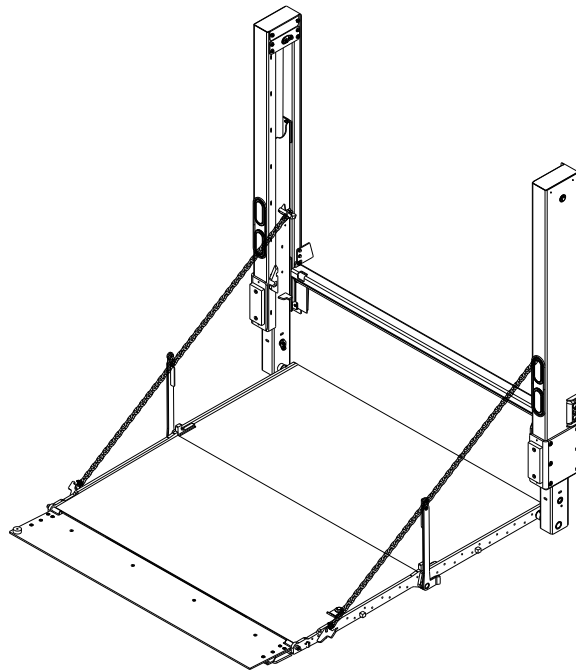

PTV 35/44/55/66 Owner's Manual
Document Part Number: 90-1121-101 / 21-680_90-00_01-01
ECN-M1723, Rev. 1.2, 12-14-23
Copyright © 2023 Palfinger Interlift, LLC.
All rights reserved.

Information in this document is subject to change without notice.
Visit www.palfinger.com for up to date information and notifications.

If you received this product with damaged or missing parts,
contact INTERLIFT Liftgates at (888)-774-5844

Parts Order
liftgateparts@palfinger.com

Technical Support
technicalapplications@palfinger.com



15939 Piuma Ave.
Cerritos, CA 90703
Tel (888) 774-5844
Fax (562) 924-8318



572 Whitehead Road.
Trenton, NJ 08619
Tel (609) 587-4200
Fax (609) 587-4201

Introduction

Thank you for purchasing a INTERLIFT Liftgate! Your PTV series liftgate is an example of the latest engineering technology in the industry. With proper care and operation your liftgate will provide you with reliable, dependable service for years to come.

INTERLIFT Liftgates is ready to provide you with fast action when you need sales, parts, or technical assistance. You can call the customer service department Monday to Friday 7 am to 5 pm Pacific Time or reach INTERLIFT Liftgates 24 hours a day, 7 days a week through the internet home page (www.palfinger.com) or voice message system. Providing quality, value and service to the customers is what our business is all about.

Read this manual carefully to learn how to operate and how to take care of your liftgate properly. Maintenance (other than the simple routine maintenance we ask you to perform within this manual, inspections, and repairs) must be completed by an **Authorized Service Center Only**. If you do not know who the **Authorized Service Center** in your area is, please contact INTERLIFT Liftgates.

Table of Contents

1	Manual Updates	- 7 -
2	Safety Information	8
3	Important Information.....	9
	3.1 Important Notes.....	10
4	General Information.....	12
	4.1 Before Operation.....	12
	4.2 Liftgate Function and Useage Information.....	12
	4.3 Improper Useage	13
5	General View of Liftgate	14
	5.1 General Figures	14
6	Maximum Load and Placement of Load on Platform	16
7	Operation of Liftgate.....	17
	7.1 Theory of Operation	17
	7.2 Operating Instructions (Standard Units).....	17
	7.3 Dock Loading – Lowering Platform (Standard Unit).....	22
	7.4 Operating Instructions (Bottle Units).....	23
	7.5 Auxiliary 3-Button Hand Held Control.....	30
	7.6 Cart Stops.....	31
	7.7 Aluminum Retention Ramp.....	33
8	Preventative Maintenance and Quick Check	34
	8.1 Quick Check List	34
	8.2 Maintenance and Care.....	35
	8.3 Trailer to Tractor Ground Test.....	36
	8.4 Lubrication	37
	8.5 Checking and Changing the Oil.....	38
	8.6 Decal Placement and Inspection	40
9	Troubleshooting.....	43
	9.1 Basic Function Check.....	43
	9.1.1 Liftgate is competely Dead (No Clicking or Movement at all)	43
	9.2 Battery Wiring – Truck Kit.....	45
	9.4 Battery Wiring – Trailer Kit.....	46
	9.5 Electrical Schematic Overview	48
	9.6 Control Board Codes.....	49
	9.7 Hydraulic Schematic.....	50

10 Required Information for Ordering Spare Parts and Repairs51

 10.1 Ordering Spare/Replacement Parts.....51

 10.2 Repairs.....51

11 Warranty52

12 Contact Address53

Company Information:

Company Name: _____

Advisor Name: _____

Trailer/Truck Year Make & Model: _____

Liftgate Information:

Liftgate Serial Number: _____

Liftgate Model Number: _____

Date of Purchase: _____

Date of Installation: _____

1 **Manual Updates**

Revision	Description
v1.0	<ul style="list-style-type: none"><li data-bbox="326 401 537 428">• Initial Release
v1.1	<ul style="list-style-type: none"><li data-bbox="326 453 870 480">• Added Section 7.3 – PTV-BG Operation
v1.2	<ul style="list-style-type: none"><li data-bbox="326 506 878 533">• Changed logos, from Palfinger to Interlift

2 Safety Information

This manual follows the Guidelines set forth in "ANSI Z535.4-2007" for alerting you to possible hazards and their potential severity.



This is the safety alert symbol. It is used to alert you to potential personal injury hazards. Obey all safety messages that follow this symbol to avoid possible injury or death.

DANGER

! DANGER indicates an imminently hazardous situation which, if not avoided, will result in death or serious injury.

WARNING

! WARNING indicates potentially hazardous situation which, if not avoided, could result in death or serious injury.

CAUTION

! CAUTION indicates a potentially hazardous situation which, if not avoided, may result minor or moderate injury.

CAUTION

CAUTION without the safety alert symbol is used to address practices not related to personal injury. *(In this manual we use it to alert you to potentially hazardous situation which, if not avoided, may result in property damage.)*

NOTICE

NOTICE without the safety alert symbol is used to address practices not related to personal injury. *(In this manual we use it to alert you to special instructions, steps, or procedures.)*

3 **Important Information**

Before Getting Started

“READ FIRST”

NOTICE

Before starting any operations of the liftgate, please read and understand this Owner's Manual. The intention of this manual is to provide the user with a guide for the operation as well as preventive maintenance. Do not attempt to modify or repair the liftgate unless performed by qualified personnel. Please contact your nearest INTERLIFT Liftgates distributor or INTERLIFT Liftgates in California or New Jersey for assistance if you have any questions regarding installation, operation or maintenance at 888-774-5844.

This owner's manual applies to the following models: **PTV/PTV-BG 35, 44, 55, 66**

Maximum Capacity for liftgate models is as follows:

- PTV 35 - Capacity: 3500 lbs.
- PTV-BG 35 - Capacity: 3500 lbs.
- PTV 44 - Capacity: 4400 lbs.
- PTV-BG 44 - Capacity: 4400 lbs.
- PTV 55 - Capacity: 5500 lbs.
- PTV 66 - Capacity: 6600 lbs.

3.1 Important Notes

The electric supply is taken from the battery kit in the Power Pack Box. If the vehicle battery is not sufficient, additional batteries need to be installed. The electric control power is secured via a fused circuit and an on-off switch located inside the cab.

The PTV series liftgate is a 100% level-ride, rail style vertical lift liftgate.

- Rail style liftgates have two rails mounted to the rear of your vehicle, either by welding or bolting. These rails support a platform which raises and lowers cargo.
- The hydraulic power unit is easily accessible for service and exchange.
- The piston rods are treated against corrosion. The Hydraulic Power Unit is equipped with a built-in pressure relief valve, which prevents overloading when lifting.



The valves do not prevent overloading of the platform when lowering.

Additional safety features are:

- Pressure compensated flow control valve.
- Tread plate platform.
- Platform safety lock.
- Warning decals and manuals.

⚠ WARNING

Improper operation of this liftgate may result in severe personal injury or death. DO NOT operate unless you have been properly instructed, have read and are familiar with the procedures in this manual. This manual has been designed to illustrate the steps needed for the basic operation of the PTV liftgate. It also provides safety information and simple preventive maintenance tips.

NOTICE

This manual is not intended for use as a repair or troubleshooting guide. Repairs should be performed by a INTERLIFT Liftgates Authorized Service Center.

This Manual has been designed for use in conjunction with only the PTV series liftgates which are designed for different capacities. There are four options available to determine the model and serial number of the installed liftgate:

- 1) Refer to the serial number tag on the liftgate (Located on Left Side Column- shown below):

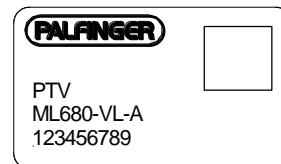
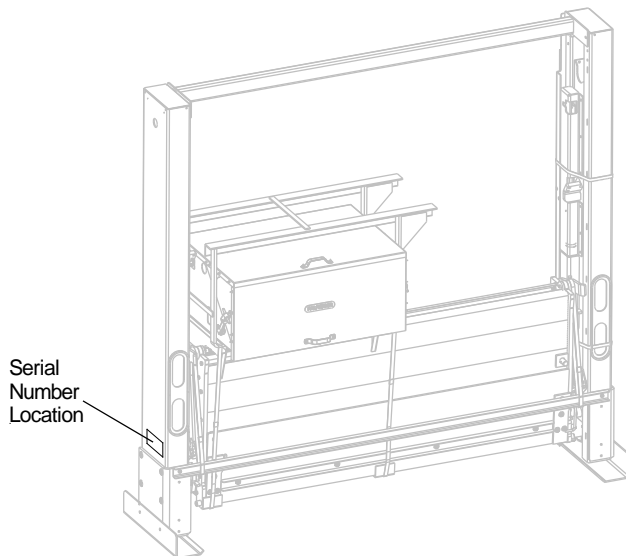

OR

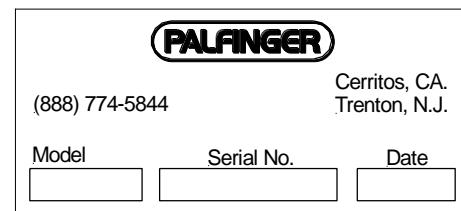

- 2) Ask your employer or lessor.
- 3) Call your INTERLIFT Liftgates Authorized Service Center for assistance.
- 4) Call INTERLIFT Liftgates for assistance in the USA at 888-774-5844. You can also contact INTERLIFT Liftgates by fax (562) 924-8318 or on the internet- www.palfinger.com

For technical support, contact INTERLIFT Liftgates or an authorized INTERLIFT service center. www.palfinger.com

Replacement manuals are available at <https://www.palfinger.com/en-us/products/liftgates>

4 General Information

4.1 Before Operation

REMEMBER:

It is the fleet manager's responsibility to educate the operator on the liftgate and its intended use. The operator's attention should be drawn to the permitted load limits and an understanding of the operation to ensure the safety throughout the operation.

ONE-MAN OPERATION:

Never let an "outsider" operate the liftgate while you are handling the cargo.

A "misunderstanding" can result in serious personal injury.

In the interest of safety, it is important that all operating personnel properly understand the functions of the liftgate, possible hazards, dangers, the load limits and load positioning for that specific unit.

4.2 Liftgate Function and Usage Information



Before the operator uses the liftgate, they should be thoroughly familiar with the liftgate functions and usage according to the following:

1. Improper operation of this lift can result in serious personal injury. Do not operate unless you have been properly instructed, have read and are familiar with the operating instructions. If you do not have a copy of the instructions please obtain them from your employer, distributor, or lessor as appropriate before you attempt to operate the lift.
2. Be certain the vehicle is properly and securely stopped before using the lift.
3. Always inspect this lift for maintenance or damage before using it. If there are signs of improper maintenance, damage to vital parts or a slippery platform surface, do not use the lift. Do not attempt your own repairs unless you are specifically trained.
4. Do not overload. See the Rating Label on the unit for the rated load. Remember that this limit applies to both raising and lowering operations.
5. Each load should be placed in a stable position as near as possible to the body of the truck/trailer.
6. Never stand in, move through or allow anyone else to stand in or move through the area in which the lift operates, including that area in which a load might fall.
7. This liftgate is intended for loading and unloading of cargo only. **DO NOT** use this liftgate for anything but its intended use. This is not a passenger lift. Do not ride the lift with unstable loads or in such a manner that a failure would endanger you. The lift is not equipped with a back-up system to prevent falling cargo in the event of a failure.



The maximum loads must be observed and followed!

4.3 Improper Usage

Some examples of improper use of the liftgate may include, but are not limited to:

- Using the liftgate as an elevating work platform.
- Using the liftgate to push, pull, tow loads, or other objects.
- Using the liftgate to carry people (Only the operator may travel on the platform).
- Using the liftgate to clear snow.
- Trying to use the liftgate as a “launching pad”.
- Using force of the hydraulic system to bend, shear, or break objects.
- Driving a forklift over the liftgate.
- Driving the truck or trailer with the platform open.
- Driving the truck or trailer with platform unsecured in the travel position.
- “Plowing” with the platform.

Please read through the operational and technical description of the INTERLIFT Liftgate.

Thank you for choosing INTERLIFT Liftgates.

5 General View of Liftgate

5.1 General Figures

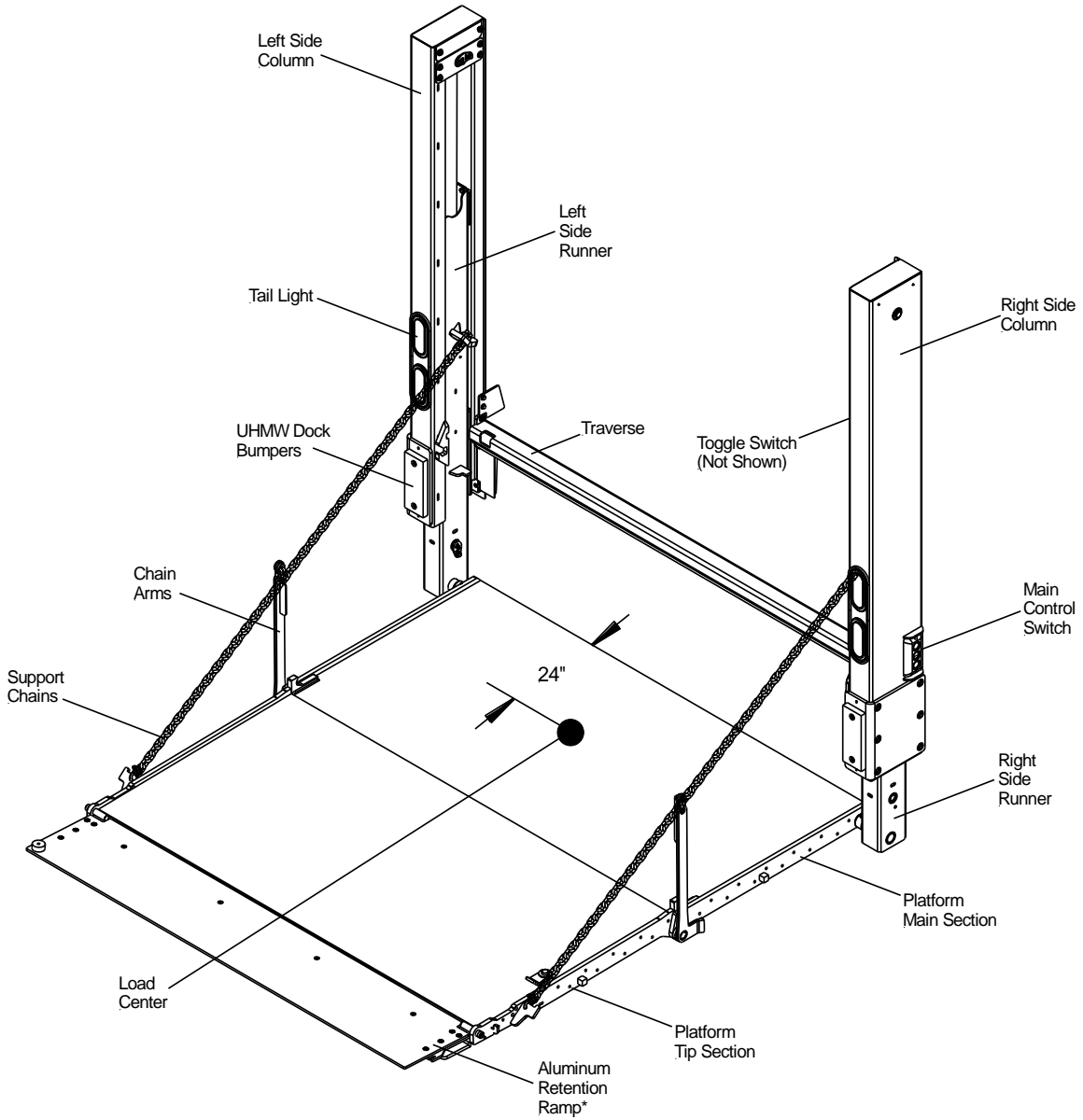

Ramp options shown below are steel platform ramps. Same options are available for aluminum platforms.

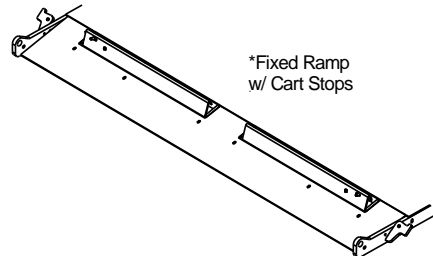
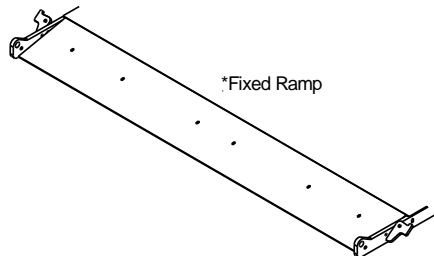

Hydraulic Enclosure: Single Pump Configuration

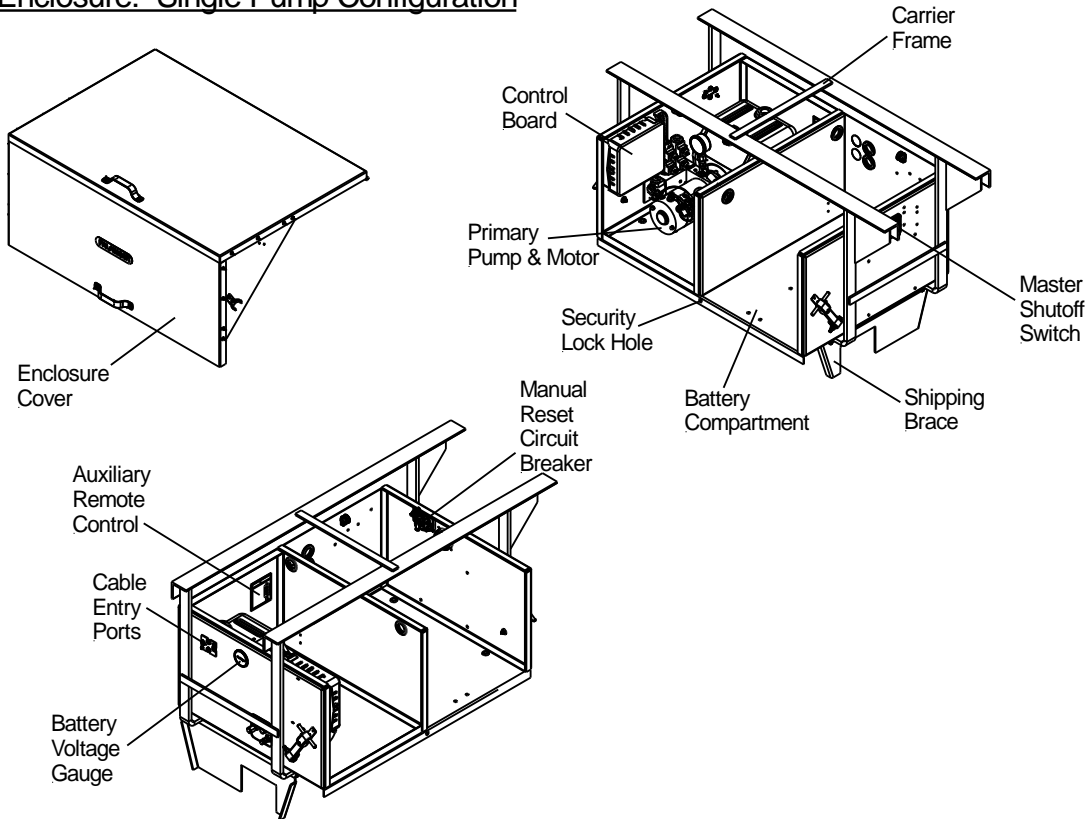

Hydraulic Enclosure: Dual Pump Configuration

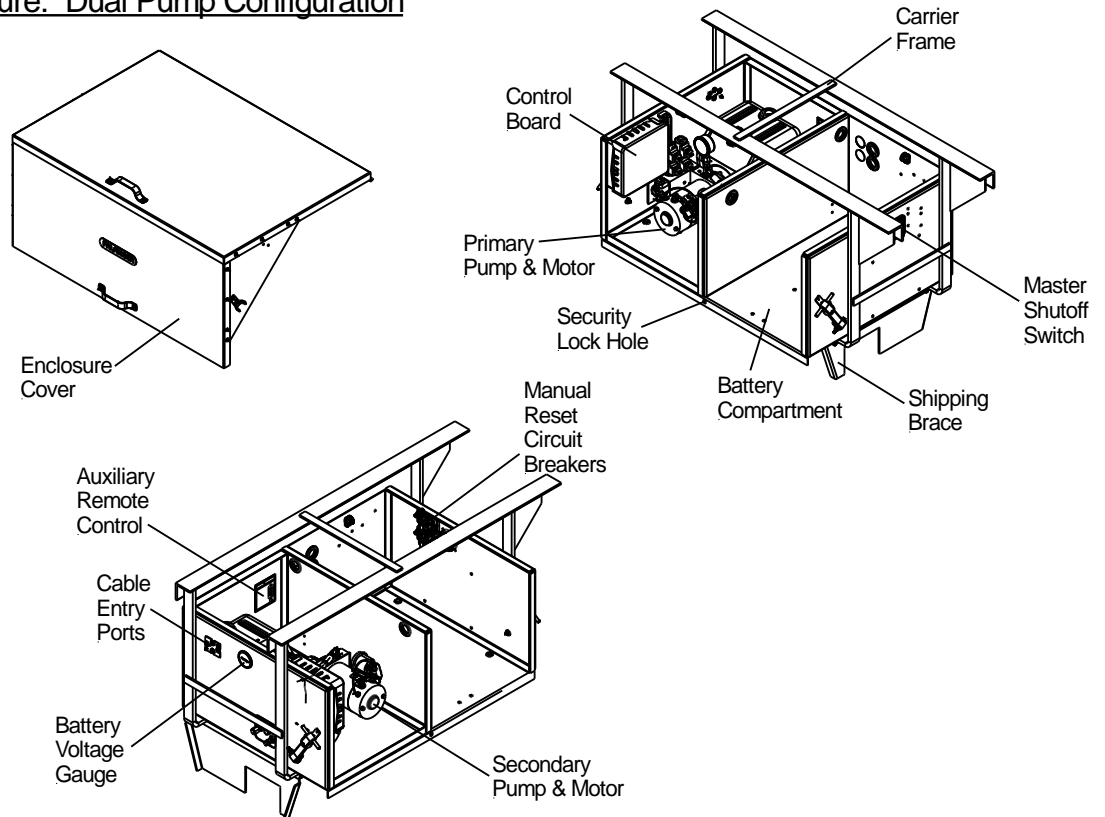

6 Maximum Load and Placement of Load on Platform

Every INTERLIFT Liftgate is rated up to a maximum load. The point of maximum load is rated at a defined distance. The center point of maximum load is 24" from the PTV traverse.

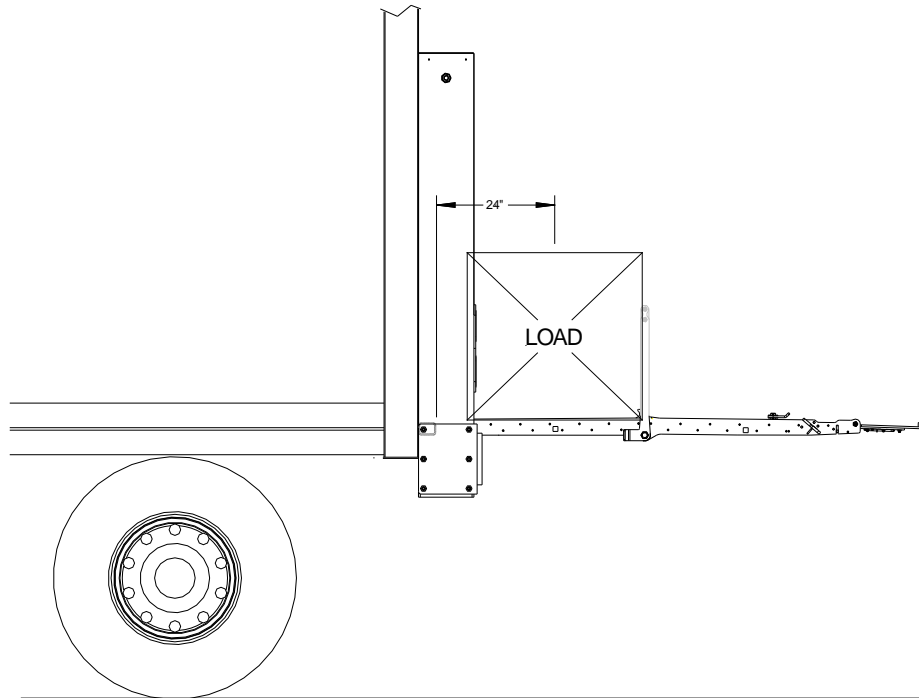

By increasing this distance, the maximum load of the lift gate is decreasing. Make sure not to overload the liftgate. Place the cargo in the middle of the platform. Operating a gate with a misplaced load may cause serious damages or even injuries to the operator.

Load Capacity vs Distance "A"

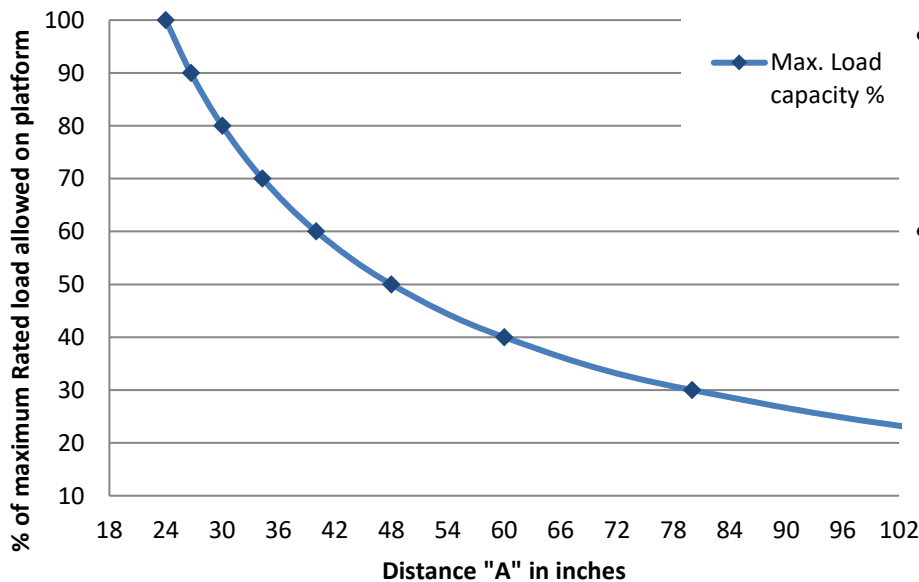

- Note that Maximum capacity is rated at 24" from the truck. As the load is placed further away from the truck, the overall capacity of the liftgate decreases.
- Never apply a load that exceeds your liftgate's maximum load rating.

7 Operation of Liftgate

7.1 Theory of Operation

The rail-type liftgate is designed to transport cargo vertically from the vehicle bed to the ground and vice versa. A hydraulic power unit provides pressure to two vertical cylinders that raise and lower the platform. Activation of a control switch supplies current from a 12-volt battery source to the hydraulic power unit. The hydraulic power unit in turn supplies hydraulic fluid to the hydraulic cylinders, causing them to retract and extend.

The platform is lowered by gravity; however, it also can be lowered by hydraulic power. Activation of the control buttons opens the hydraulic valves and directs hydraulic fluid to extend the cylinder. The downward force on the platform lowers it.

The platform is opened and closed hydraulically by the extension and retraction of the open/close cylinder.

7.2 Operating Instructions (Standard Units)

Steps:

1. Turn on power: To activate power to the liftgate, turn the master disconnect switch located on the outside of the battery box to the "ON" position

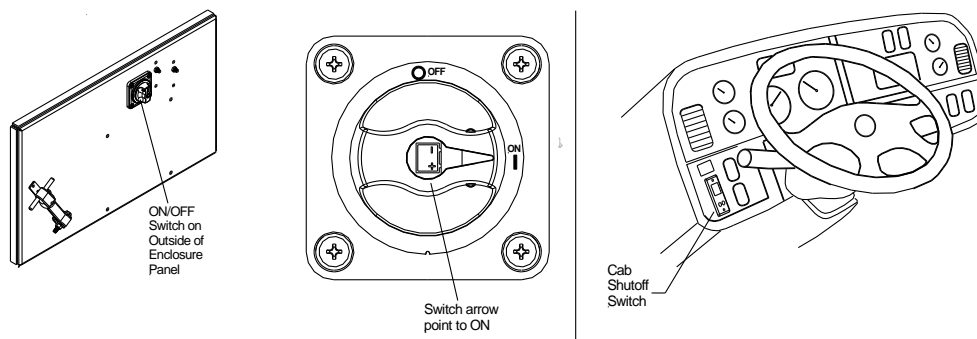

2. Open Liftgate Platform: Be certain the operating area around platform is clear before opening platform. Push and hold the "UP" button to raise the platform up so that it is completely out of the travel locks.

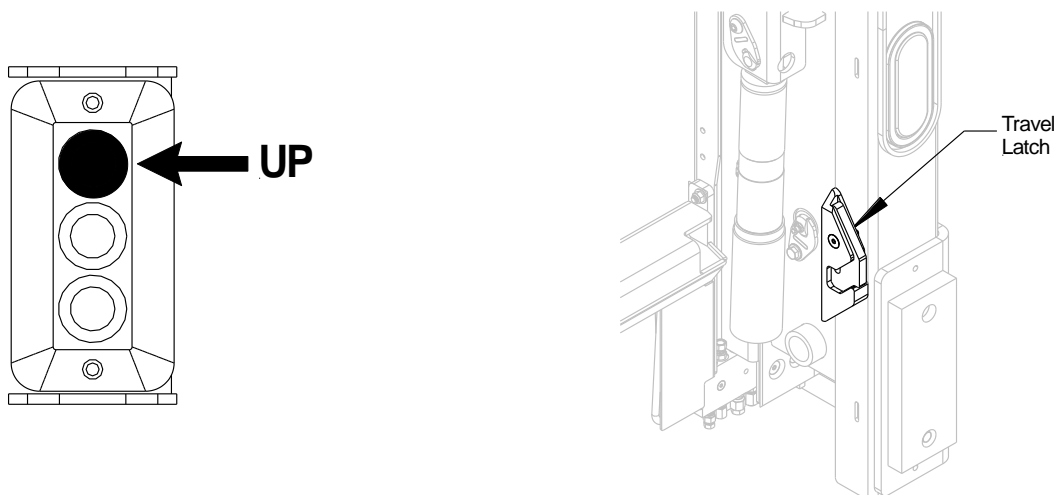

Open the Liftgate Platform (continued): Be certain the operating area around the platform is clear before opening the platform. Pushing the "OPEN" button, and "DOWN" button simultaneously will power the platform open.

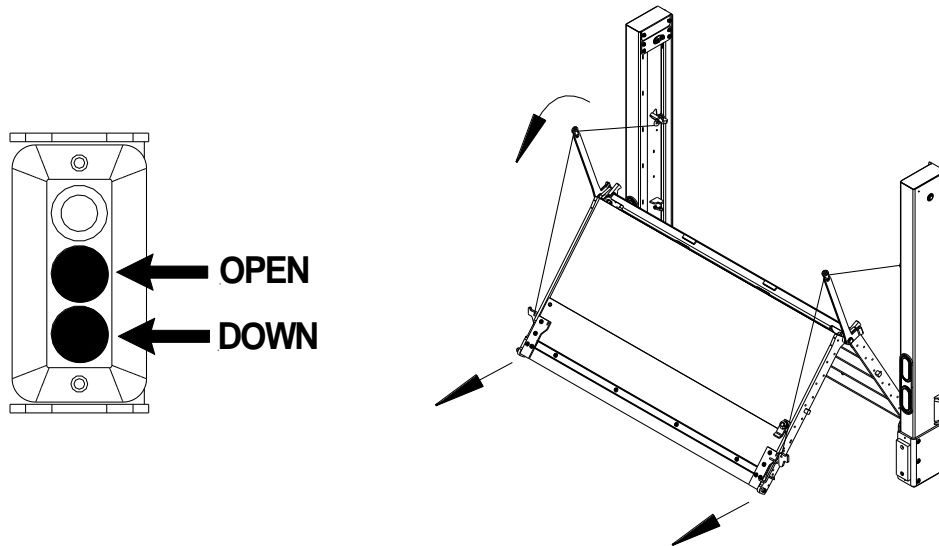

3. Lower the platform to the ground: Pushing the "DOWN" button, lower the platform to the ground.
Note: For power down operation, push the down button twice (within 3 seconds).

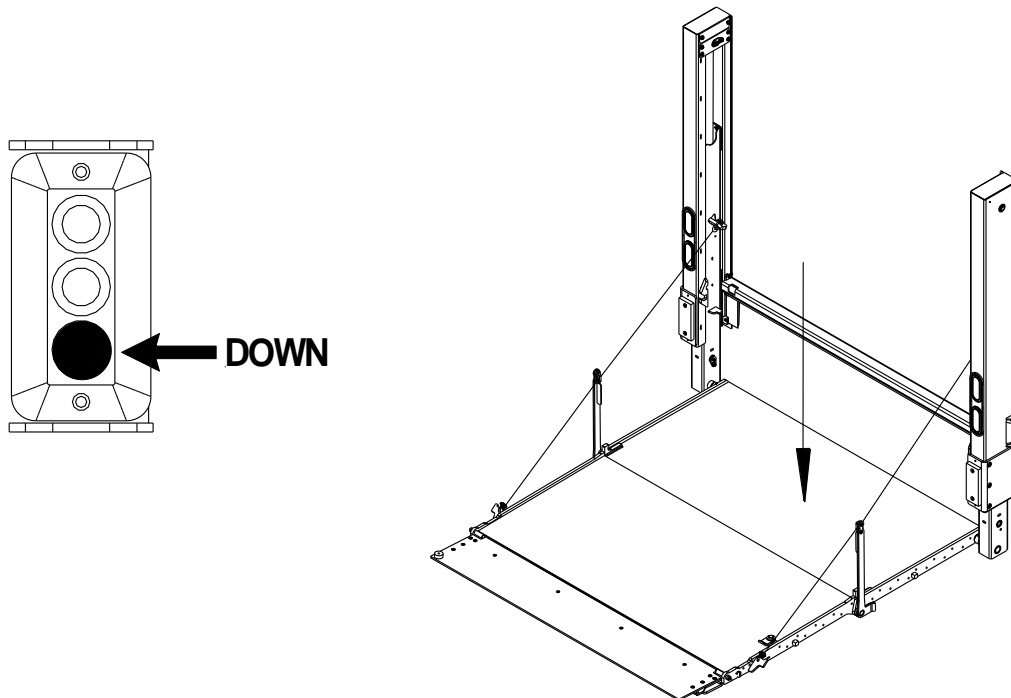

Aluminum Retention Ramp (ARR) Optional: Skip this step if the platform has a fixed ramp.

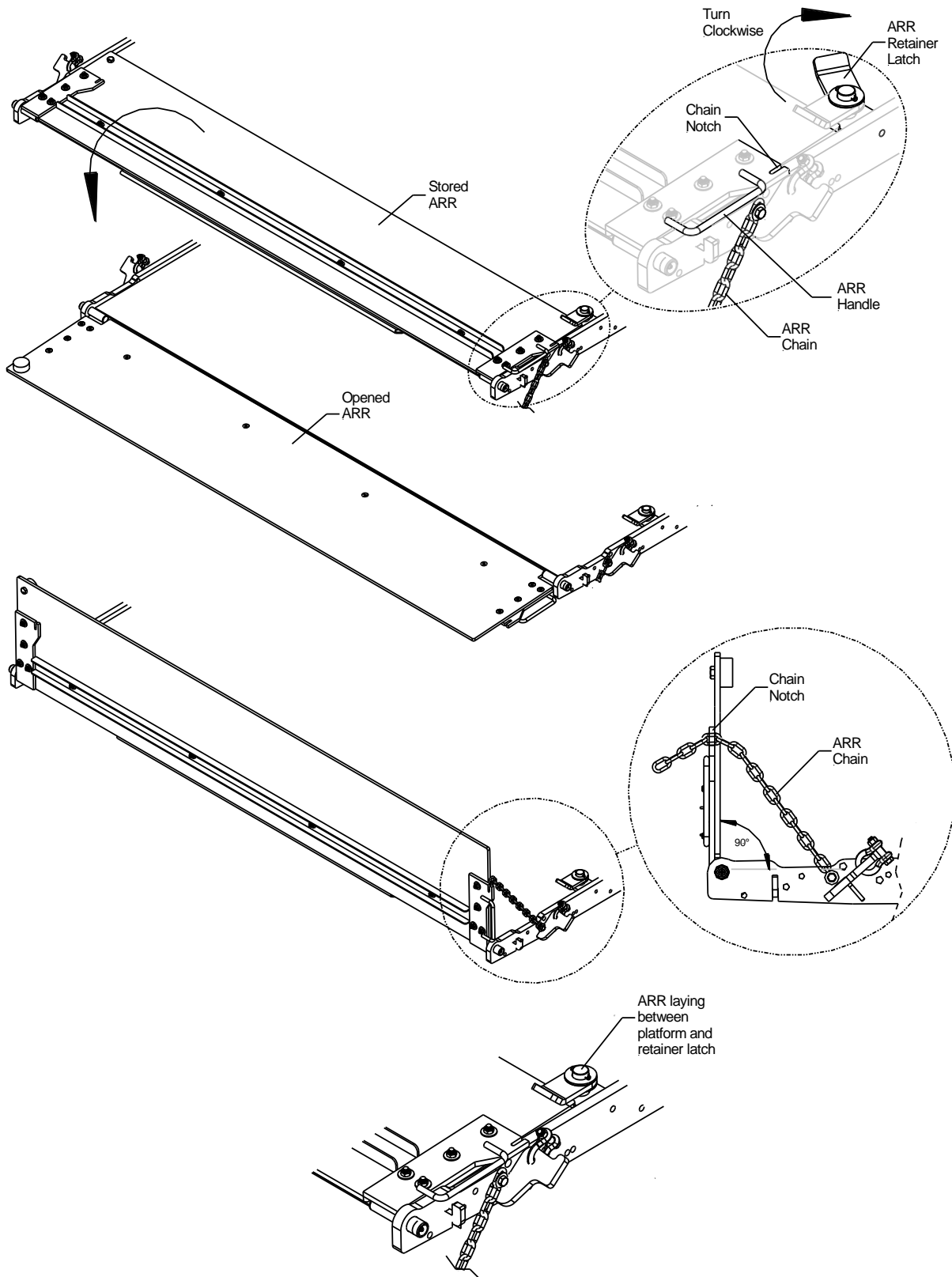

4. Raise the platform to bed level: Pushing the “UP” button, raise the platform to bed level.
5. Bleeding the system: With the platform at bed level, push the “UP” button for thirty (30) seconds. This will bypass hydraulic fluid through hydraulic poppet valves located in each of the lift cylinder pistons returning hydraulic fluid back to the reservoir via the return lines.

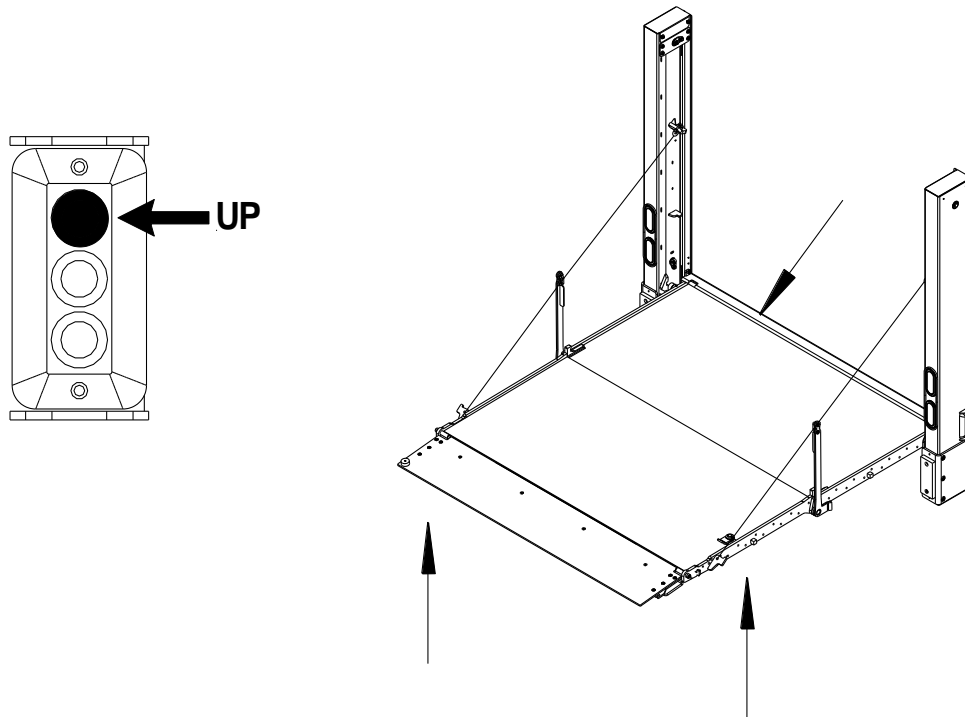

6. Closing and Storing of the Platform for transit: With the platform open at bed level use the “UP” button and “CLOSE” button together, power the platform closed.

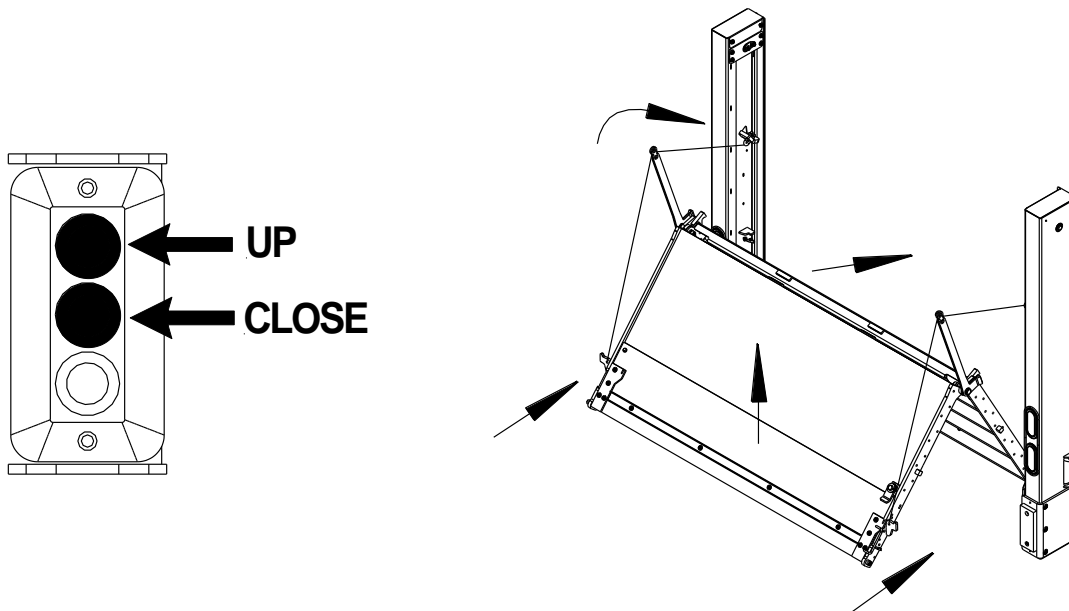

Lower the Platform: Using the “DOWN” button, push down twice (within 3 seconds) and power down platform past the Travel Locks. (See Illustration)

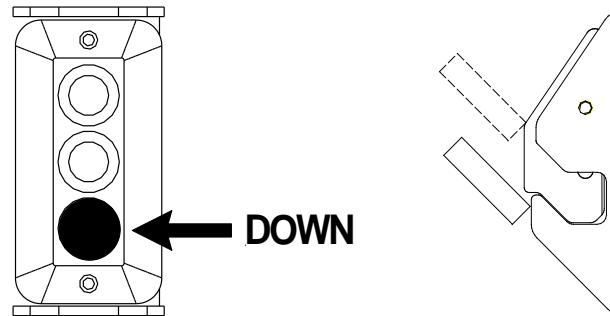

7. Raise the Platform: Using the “UP” button, raise platform up until travel ears clear the travel lock slot. (See Illustration)

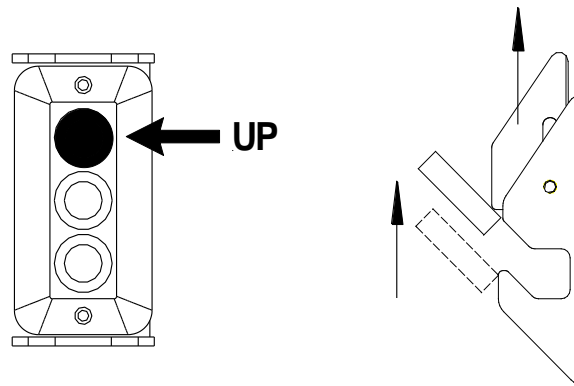

8. Lock the Platform: Once the travel ear clears the slot, use the **down button twice** (within 3 seconds) **to power down** travel ear into travel lock slot.

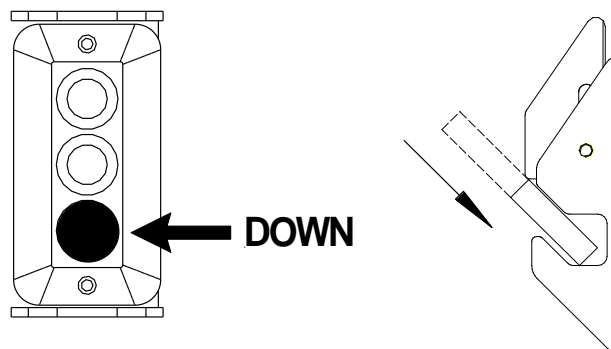

7.3 Dock Loading – Lowering Platform (Standard Unit)



When backing up vehicle to loading dock

DO NOT hit the dock. Have a second person outside the truck directing you. Hitting the dock may cause hidden damage to liftgate components. Be sure to inspect the liftgate for damage.

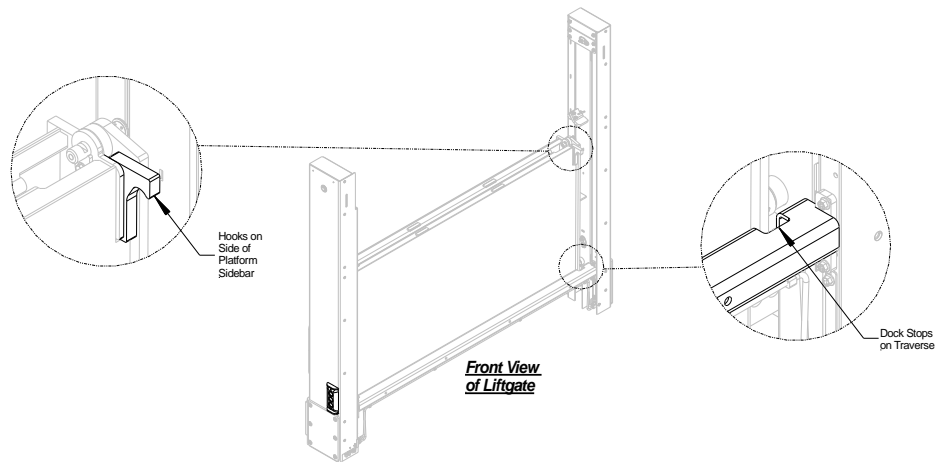

1. Using the “UP” button to power platform up so that it is completely out of the travel locks.

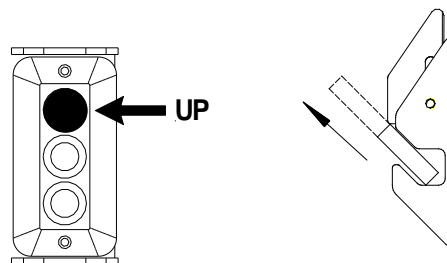

2. To lower platform down push **Down Button twice** (within 3 seconds) until the platform passes the travel latch and is level with the vehicle floor and rests on the Dock Stops.

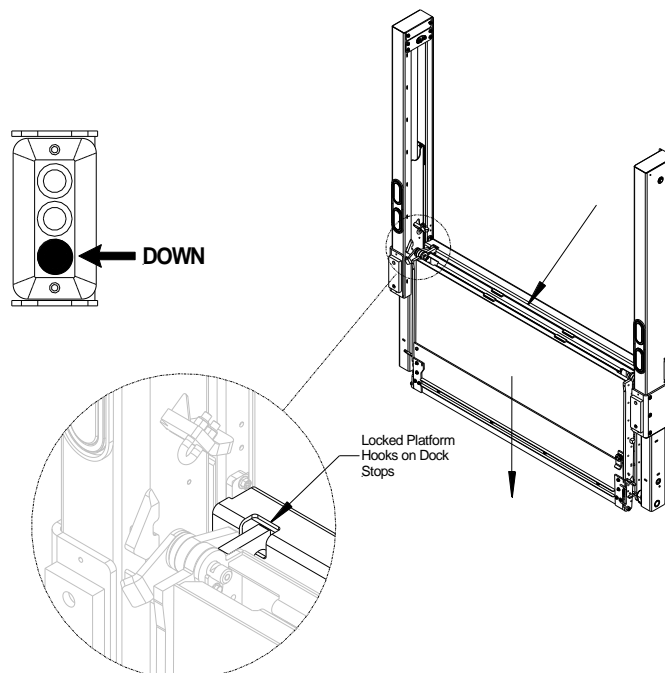

Bottle Gas Units

7.4 Operating Instructions (Bottle Units)

Steps:

1. **Turn on power:** To activate power to the liftgate, turn the master disconnect switch located on the outside of the battery box to the "ON" position. If the vehicle has a cab switch, verify that its turned ON also.

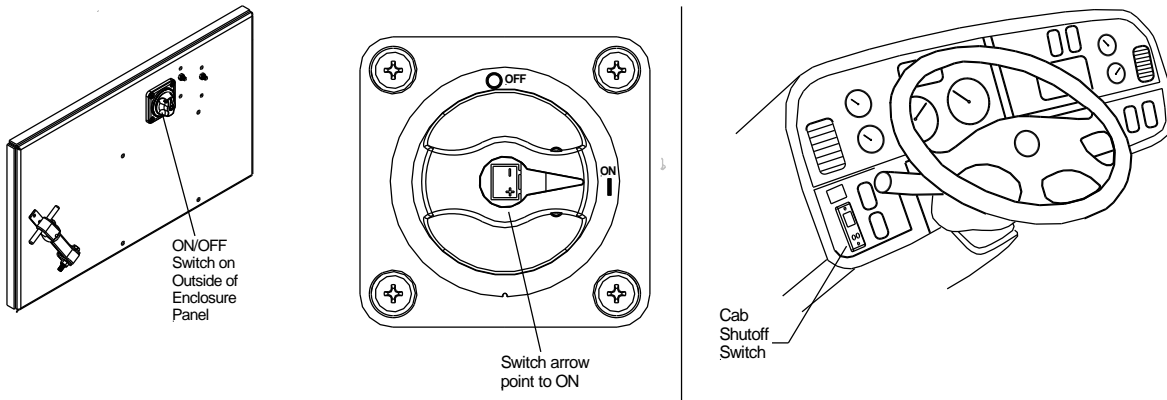

2. **Open Liftgate Platform:** Be certain the operating area around platform is clear before opening platform. Pushing the "UP" button, raise the platform up so that it is completely out of the travel locks.

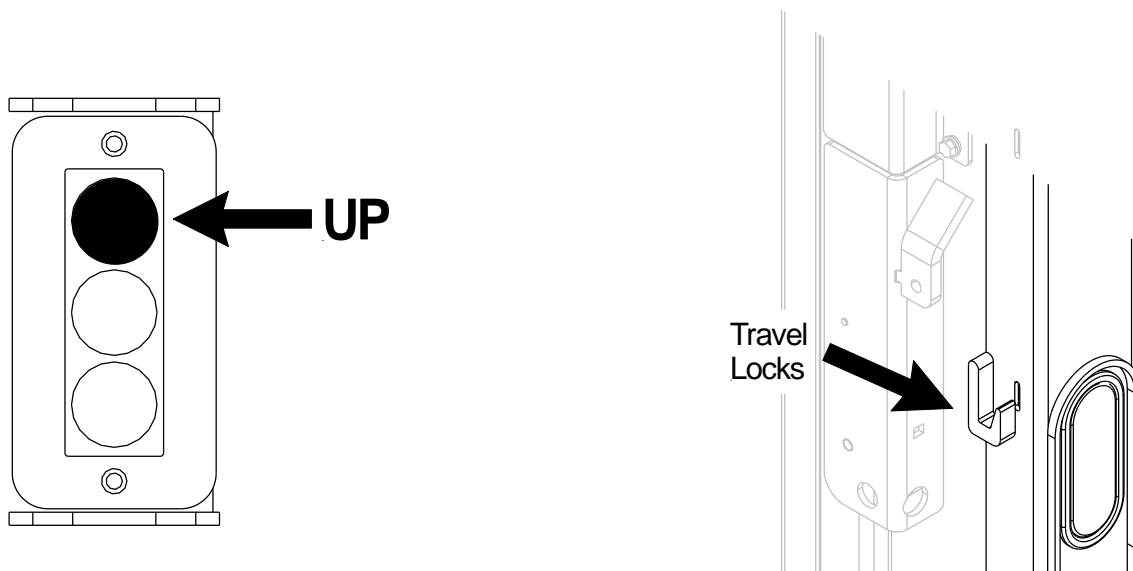

Bottle Gas Units

Open Liftgate Platform (continued): Be certain operating area around platform is clear before opening platform. Push the "DOWN" button, and "OPEN" button together to power the platform open.

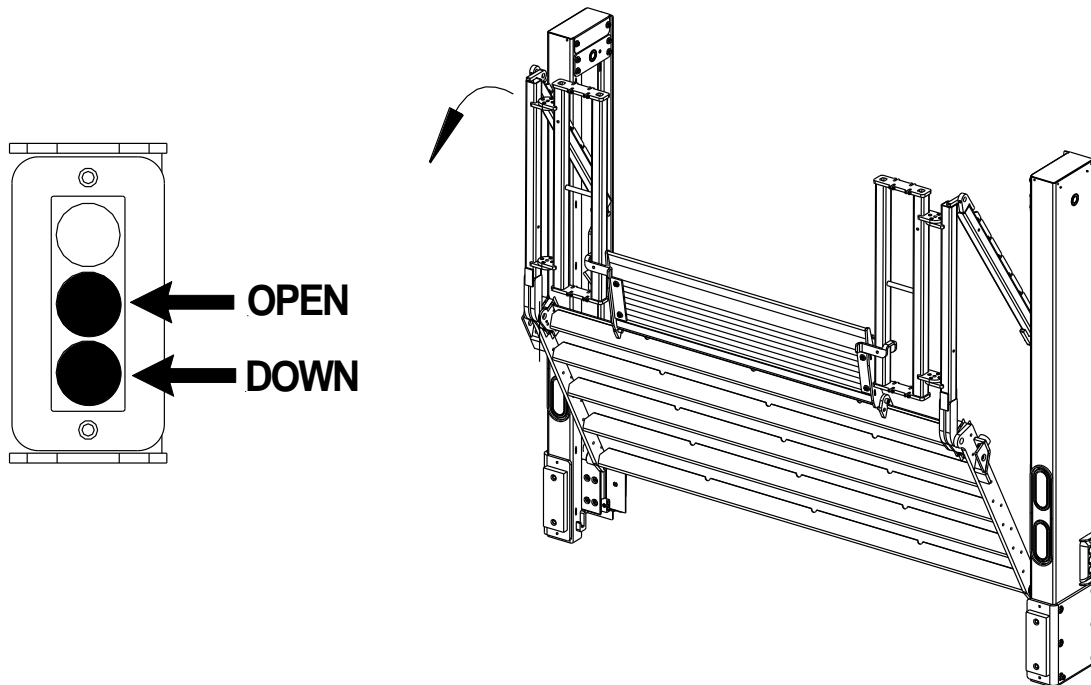

- Lower the platform to the ground: Pushing the "DOWN" button, lower the platform to the ground. Note: for power down operation, push the down button twice (within 3 seconds).

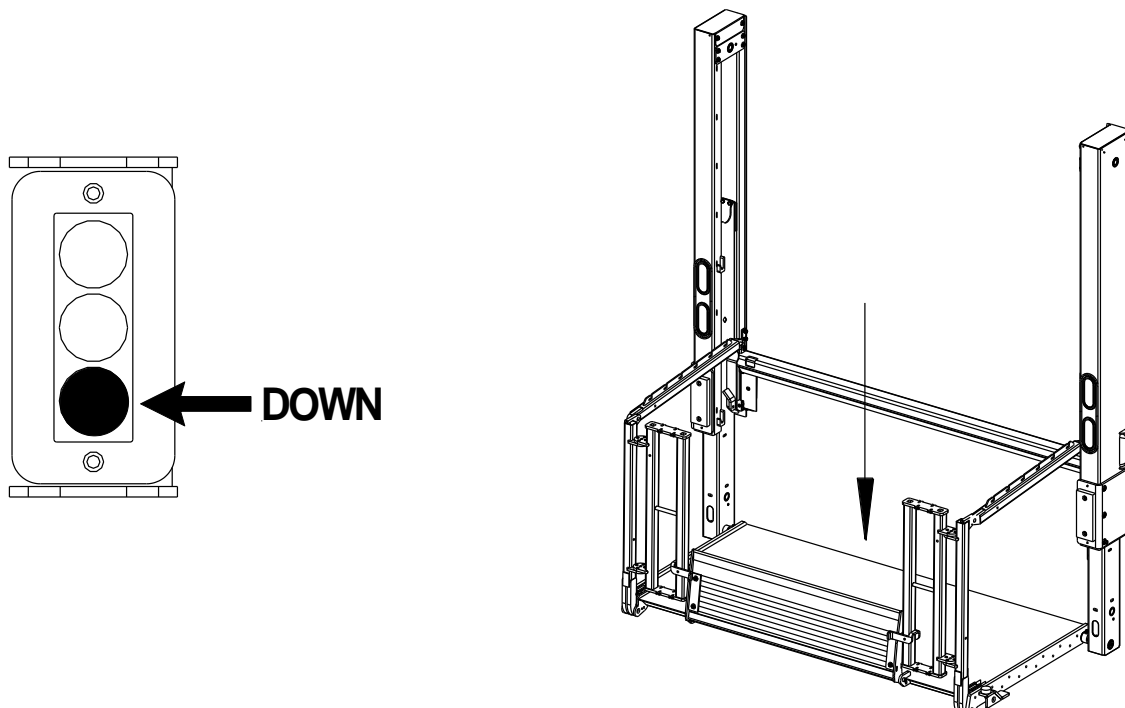

Bottle Gas Units

4. Raise the platform to bed level: Pushing the “UP” button, raise the platform to bed level.
5. Bleeding the system: With the platform at bed level, push the “UP” button for thirty (30) seconds. This will bypass hydraulic fluid through hydraulic poppet valves located in each of the lift cylinder pistons returning hydraulic fluid back to the reservoir via the return lines.

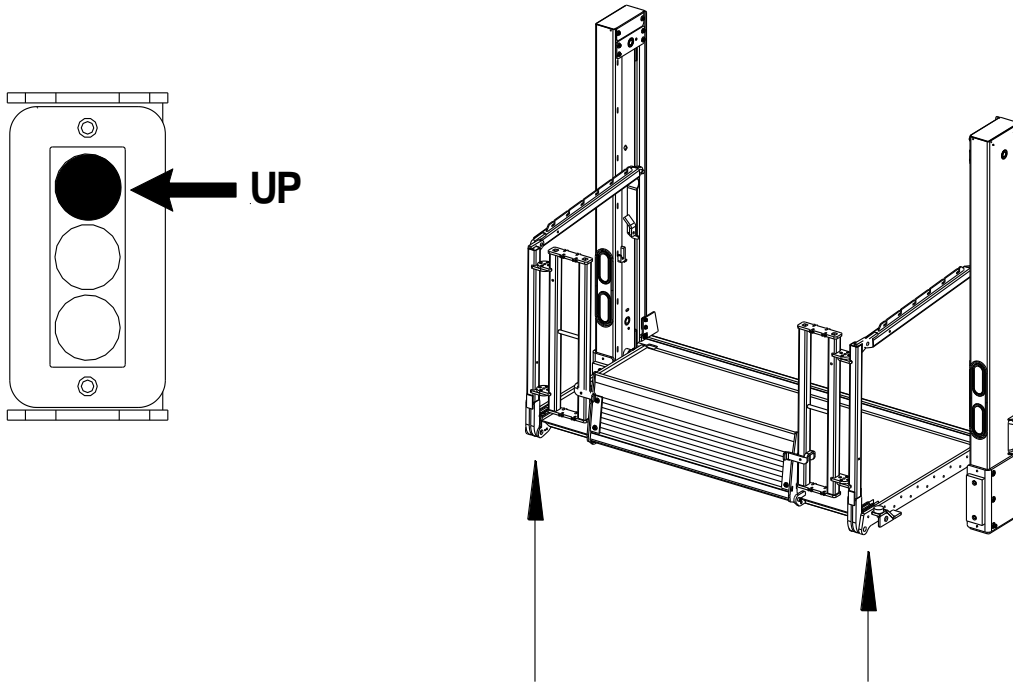

6. Closing and Storing of the Platform for transit: With the platform open at bed level use the “UP” button and “CLOSE” button together, power the platform closed.

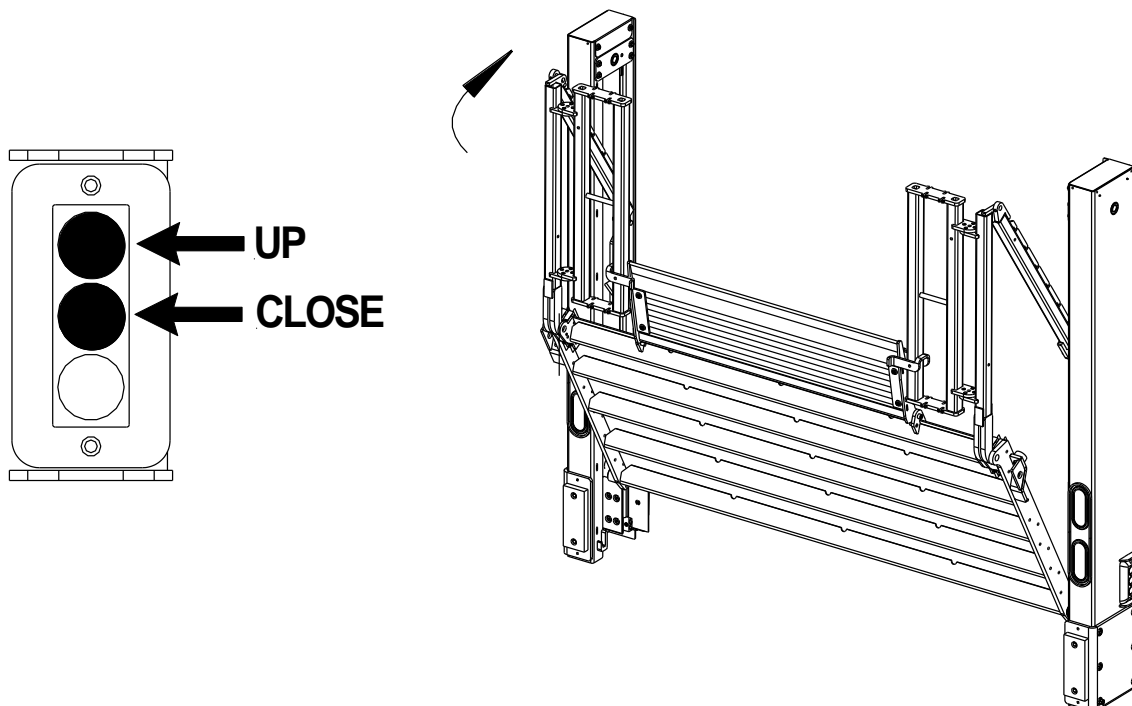

Bottle Gas Units

7. Lower the Platform: Using the "DOWN" button, push down twice (within 3 seconds) to power down the travel ear into travel locks. (See Illustration)

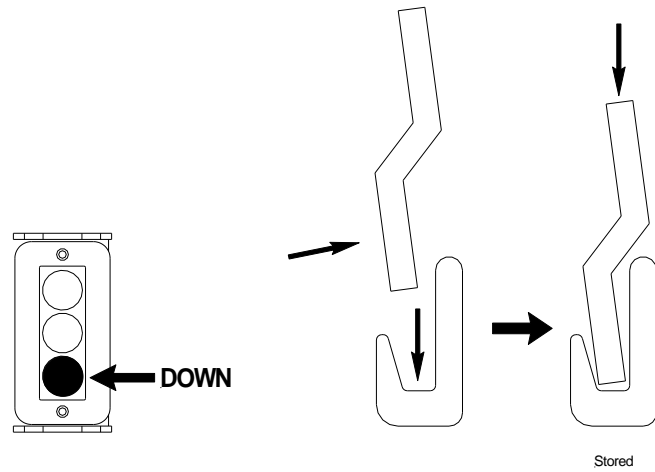

The platform should now be in stored/ transit position, as shown below.

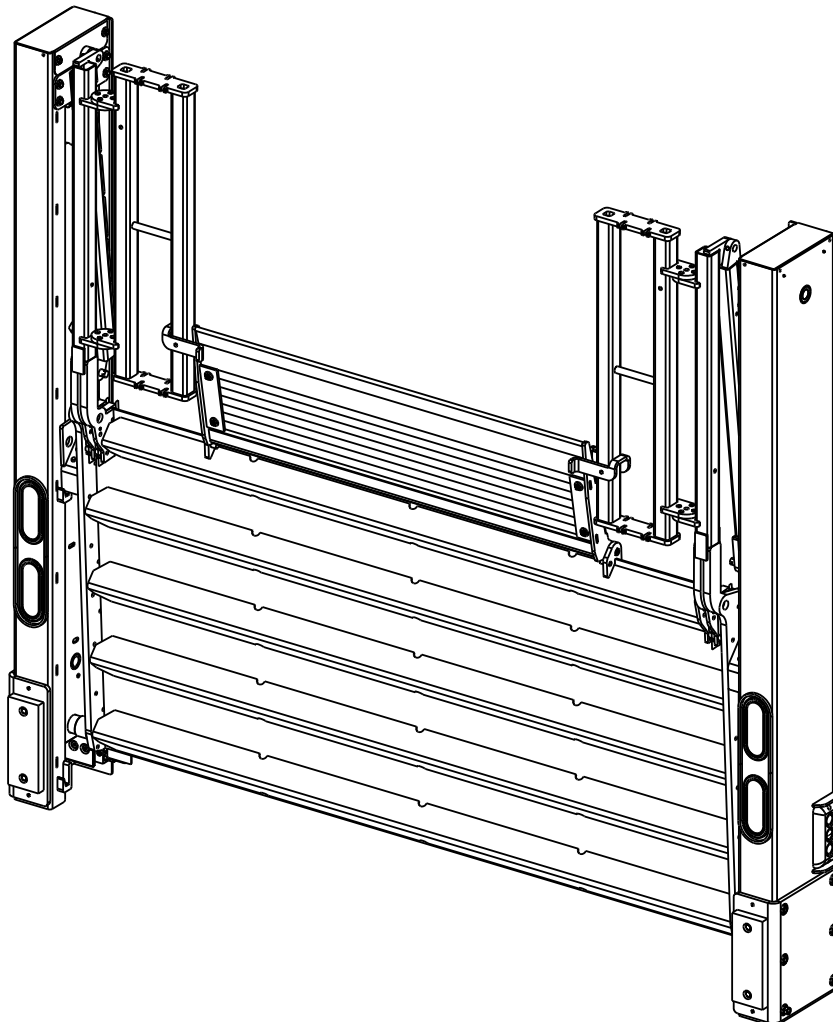

Bottle Gas Units

During the operation of the liftgate, the ramp will be in one of the three positions shown below.

Curb Side View of Ramp Positions

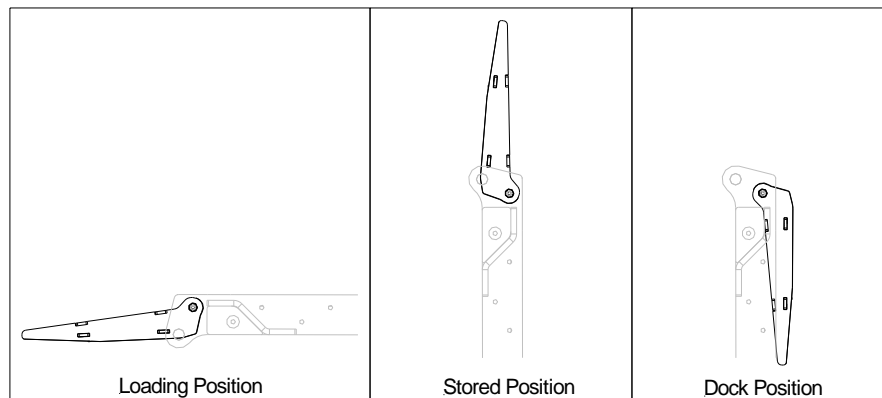

“Loading” position (Position 1 above) is achieved with the gate completely lowered to the ground, platform out, and the ramp out.

To open the ramp, flip the ramp latches to a vertical position to release the ramp.

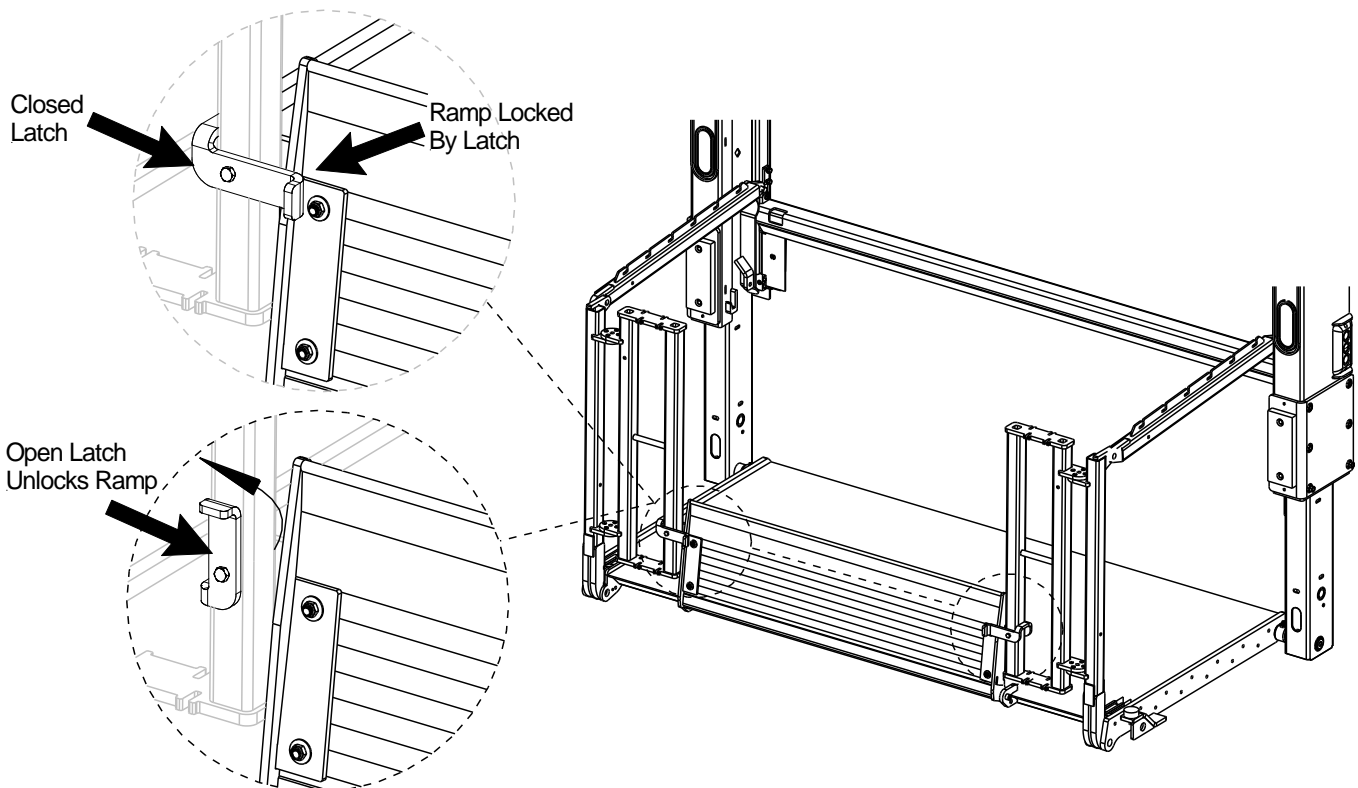

Bottle Gas Units

The swing doors can open in a 180° range. Lift the swing door vertically, and pivot the door in the direction you wish to open. The doors lock automatically in 3 positions.

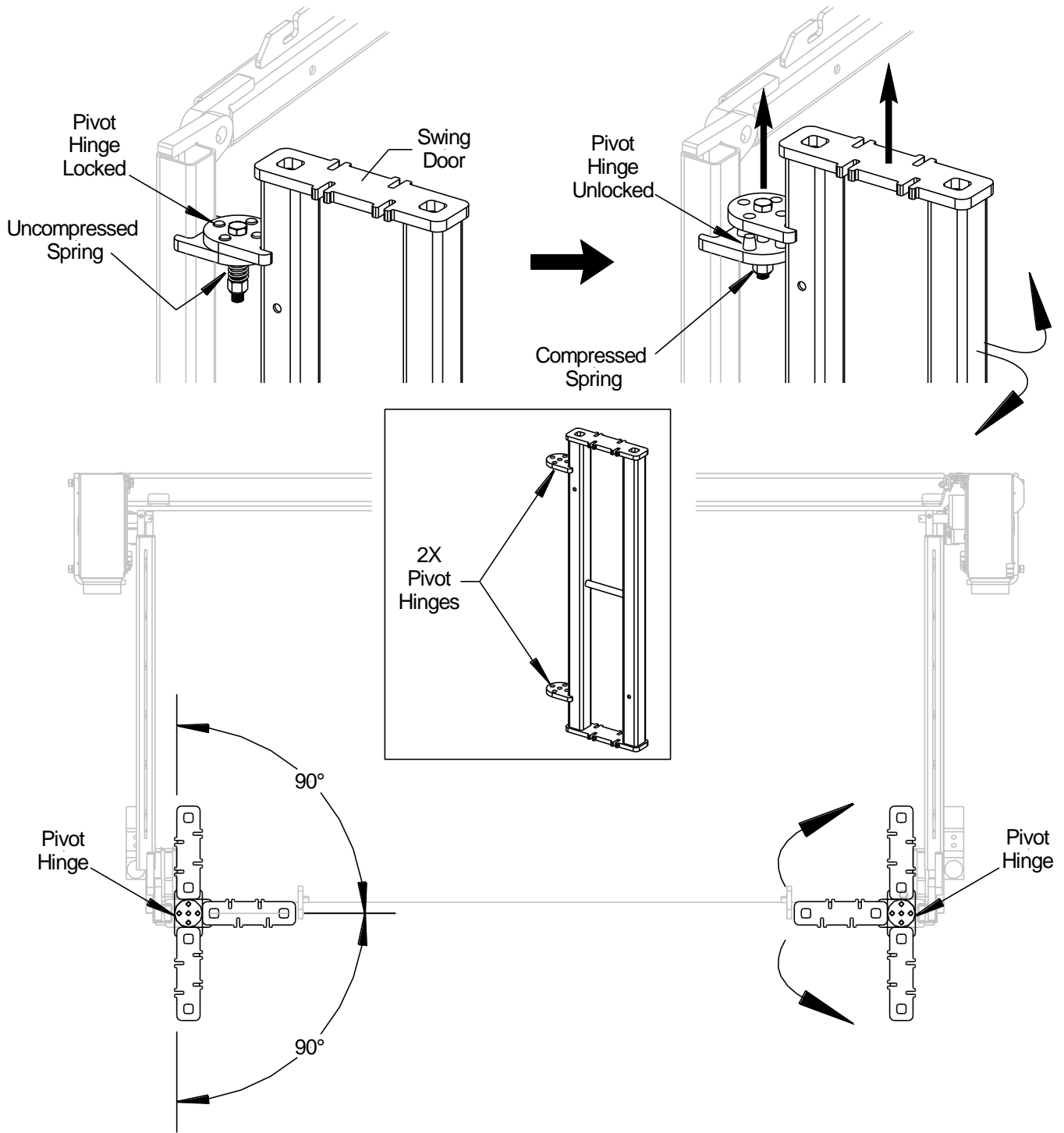

Top View of Swing Door Positions

Bottle Gas Units

“Dock Loading”: Is achieved when the platform is folded closed, and the liftgate is lowered. The ramp should be folded over, on top of the platform.

Dock Loading Operation: From the **stored** position, raise the liftgate out of the travel lock. Press the **UP** button **(A)** and the **OPEN/CLOSE** buttons **(B)** briefly to open the platform enough to clear the travel lock. Fold the ramp inward as shown below, if it is not already. Press the **DOWN** button **(C)** to lower the gate until the platform passes the travel latch and is level with the vehicle floor. Press the **UP/CLOSE** buttons **(D)** to close the platform and then press **DOWN** button **(E)** to store the platform in the lower travel lock.

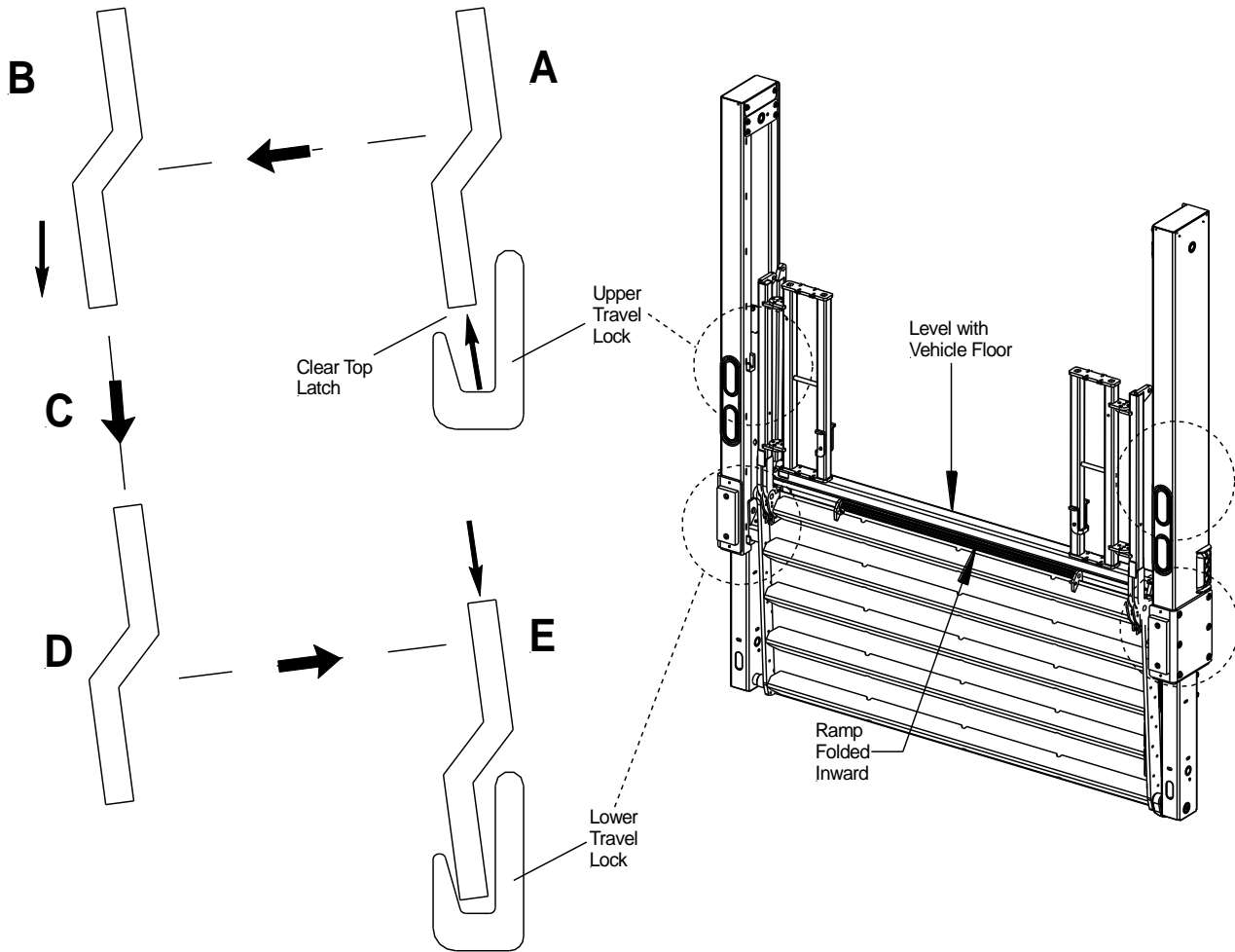

Control Switch Sequence

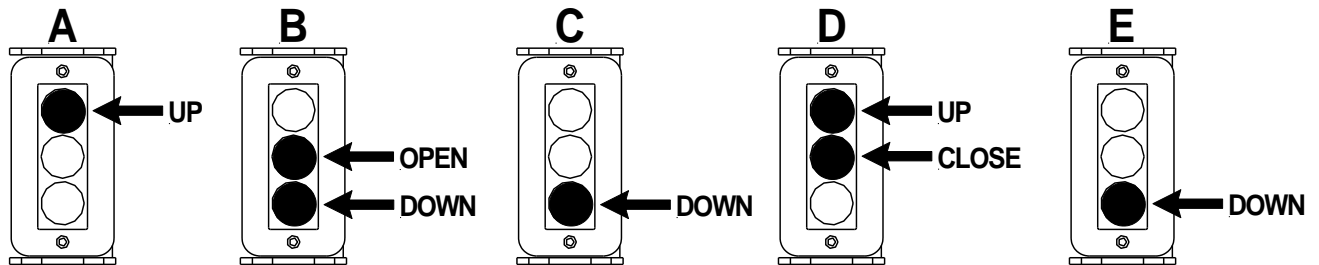

When backing up vehicle to loading dock

DO NOT hit the dock. Have a second person outside the truck directing you. Hitting the dock may cause hidden damage to the liftgate components. Be sure to inspect the liftgate for damage.

7.5 Auxiliary 3-Button Hand Held Control

The auxiliary 3-Button Handheld Control is a secondary control used for troubleshooting the PTV. The handheld control can be found on the pump side of the enclosure as shown below. The control is fully operational and can control the liftgate in the same way as the main controls located at the column, however the control is not intended for everyday use.

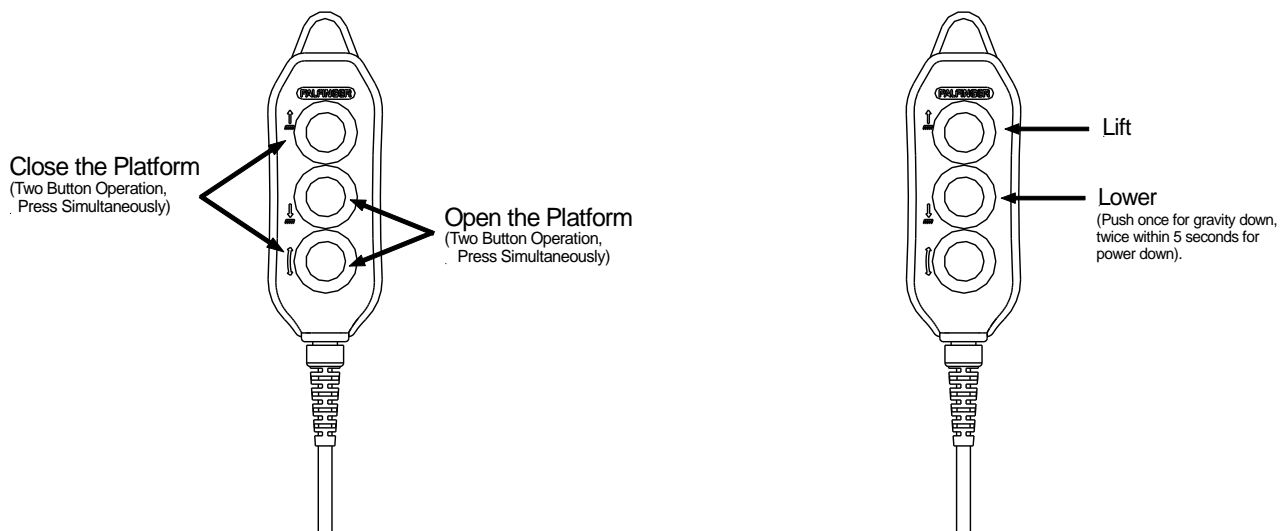
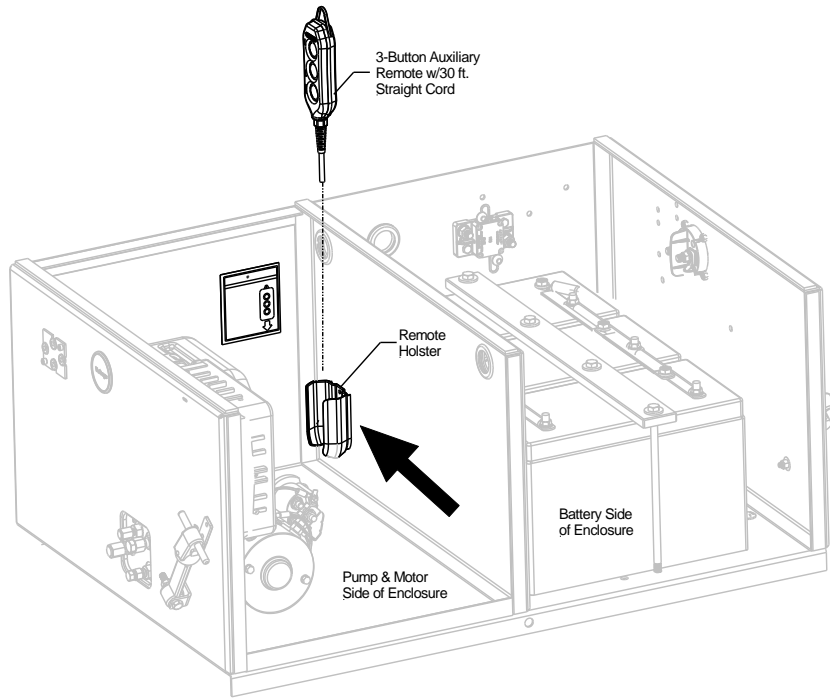

⚠ WARNING

Never operate the liftgate without a visual of the liftgate surroundings.

7.6 Cart Stops

Aluminum Platform Cart Stops

1. Push the cart stop latch out toward the curb side. The cart stop will spring open automatically once the latch has been moved from its original position.
2. To close the cart stops, push the cart stop latch inward towards the street side. After the latch is in place close each cart stop by pushing each stop down.

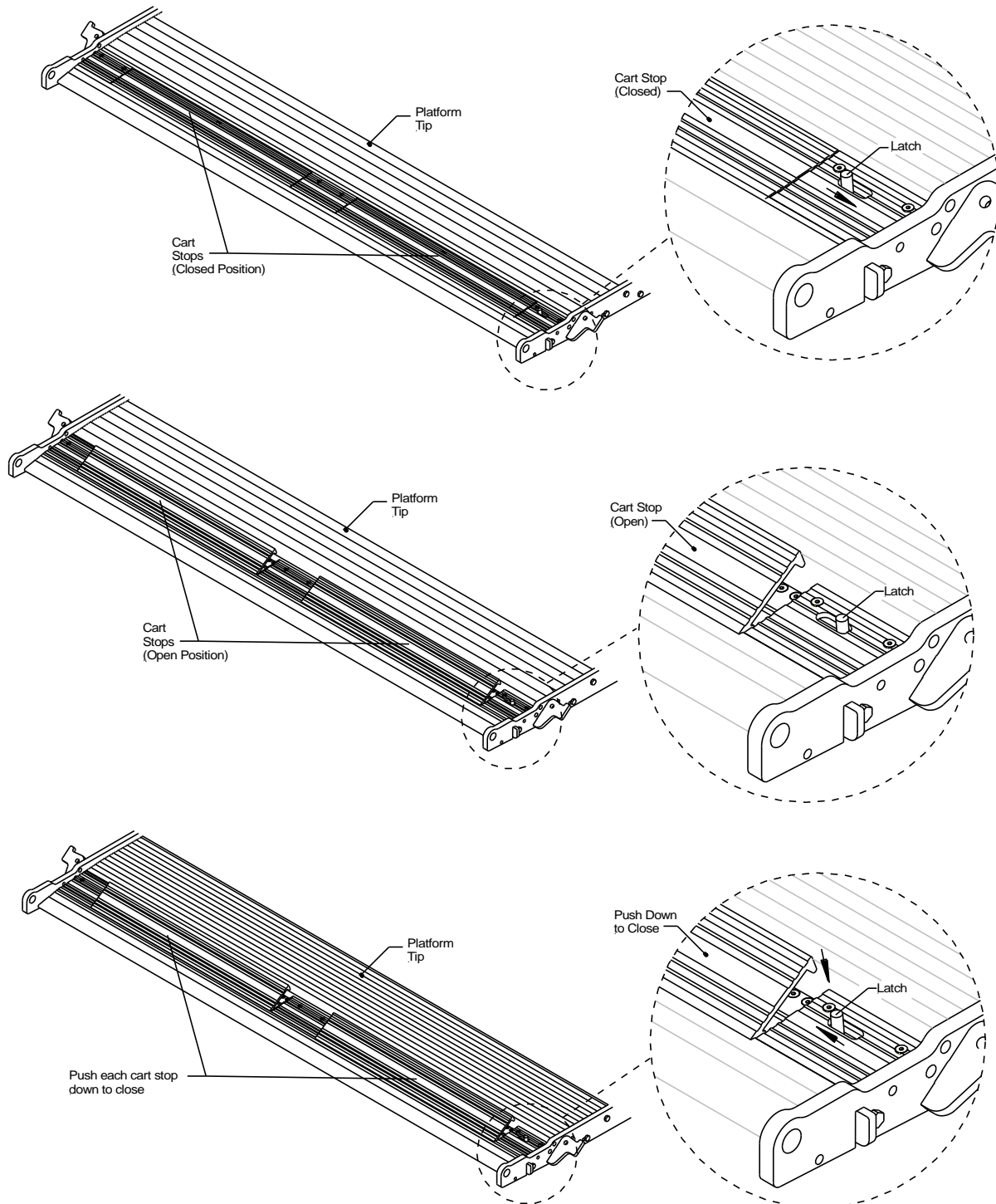

Steel Platform Cart Stops

1. Each cart stop is equipped with a retaining latch. Push each latch inward to open the cart stop. The cart stop will automatically spring open once the latch has been pushed.
2. To close the cart stop, push and hold each cart stop down in close position and lock each cart stop with the retaining latch.

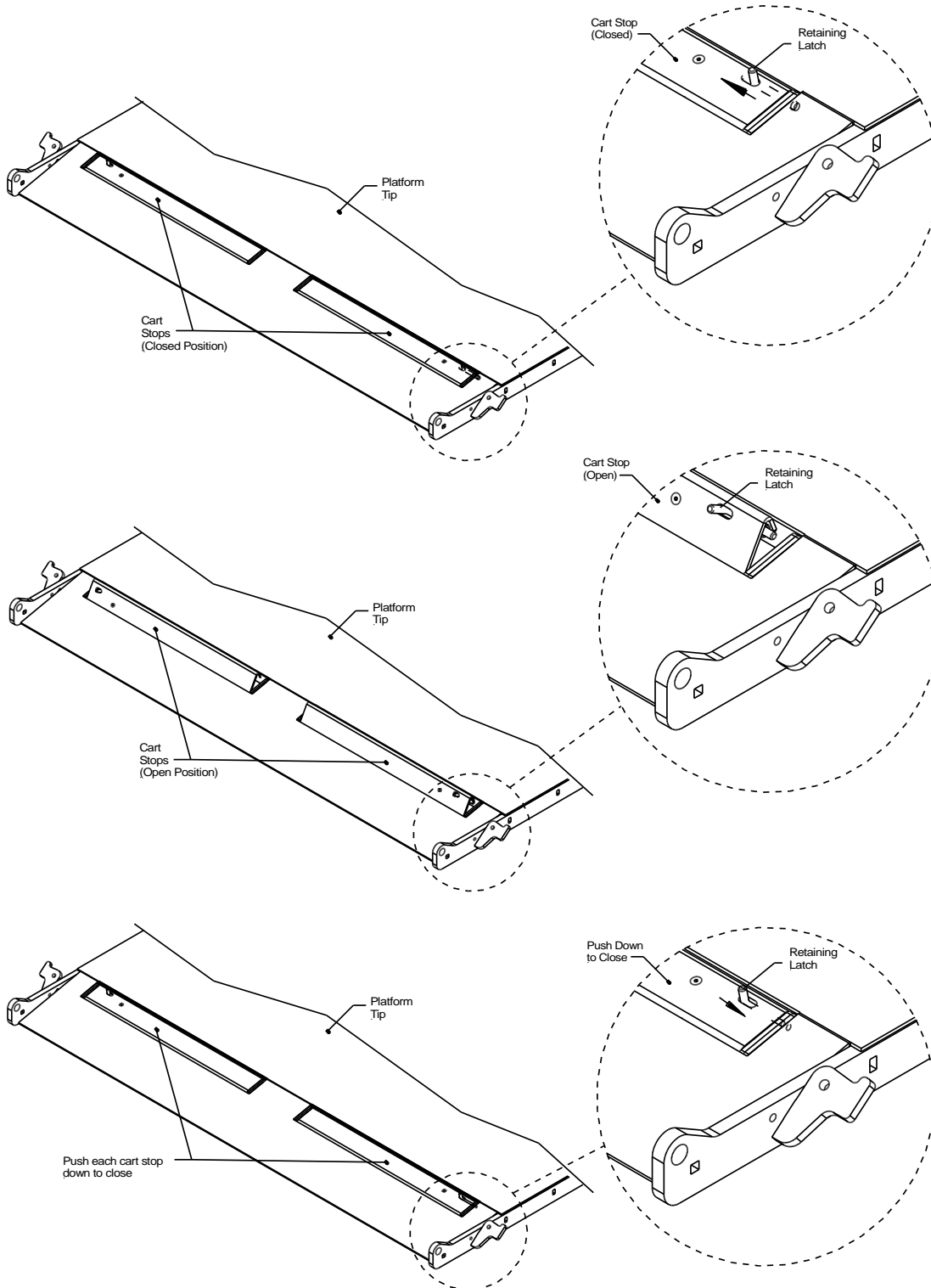

7.7 Aluminum Retention Ramp

1. Lower the platform to the ground. Turn the retainer latch clockwise to release the ramp. Use the ARR handle on the side to open the retention ramp.
2. Load platform. To use the ramp as a load retention, stop, place the ramp 90° to the platform and use the chain to secure the ramp.
3. Lower the platform down to the ground and remove the chain from the retaining notch. Place the ARR back in its original position and turn the retainer latch enough to allow the ramp to lay between the platform and retainer. Proceed to storing the platform.

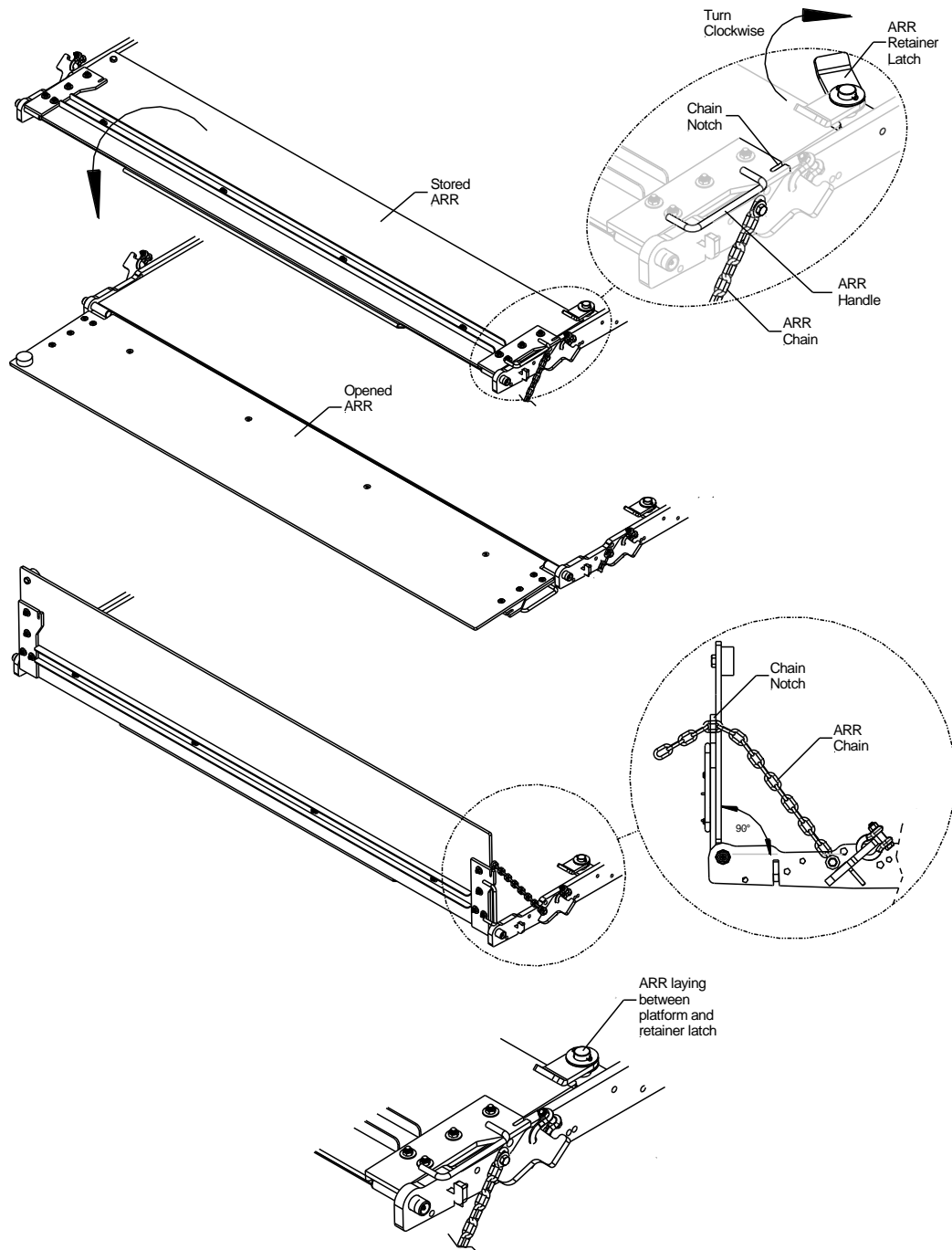

8 Preventative Maintenance and Quick Check

The PTV needs preventive maintenance in order to achieve maximum performance. Lubricate and inspect regularly. Also, check that there are no damaged components such as hoses, cables, controls, etc.

8.1 Quick Check List

1. Operate the liftgate throughout its entire cycle and check for noise and damage such as bent parts, scratches, or cracked welds.
2. Inspect all welds and fasteners that attach the mount frame to the truck.
3. Check all pin retainer lock bolts for tight fit.
4. Visually inspect the hydraulic hoses for damage, scratches, bending or leakage. Also ensure that hoses are not routed such that rubbing/wear on the hoses will occur- hoses should be securely fastened, not loose.
5. Inspect the cylinders for leakage and make sure the cylinder pins are secured.
6. Check the oil level when platform is down. The level should be approx. 1.5" below the top of the Oil Reservoir. INTERLIFT Liftgates recommends replacing oil after the first 500 cycles, and then on a yearly basis in the fall before winter begins.
7. Check for oil leakage around the power pack. Tighten or replace components if needed. If you perform work on any hydraulic components, bleed the air out of the system by operating all functions several times to self-bleed the lift cylinders. Run the gate all the way up and down to remove air from the fluid.
8. Check all electrical connections. Clean the battery terminals.
9. Inspect all terminals on the solenoid-operated valves at the port of the cylinder. Lubricate the terminals with dielectric grease for better protection from corrosion, if needed.
10. Grease all zerks and link arms on the liftgate per the lubrication instructions and make sure that they all accept grease. It helps to operate the liftgate while you do this.
11. Test all liftgates functions, if possible, with maximum loads placed according to load diagram.
12. Check the function of the pressure relief valve.
13. If you find any kind of damage that can make the operation of the liftgate dangerous, DO NOT CONTINUE TO USE THE LIFTGATE. It must be completely repaired before using. All repairs must be made by an authorized technician. Use only original spare parts. If in doubt contact your INTERLIFT Liftgates distributor or INTERLIFT Liftgates directly.
14. Perform the Trailer to Tractor Ground Test. Reference Section 8.3.



Do not ignore any liftgate damage; it can be dangerous for you and your co-workers.



IMMEDIATELY REPAIR OR REPLACE FAULTY PARTS

8.2 Maintenance and Care

The following “inspection and maintenance” should be performed at the recommended intervals based on the operation and the amount of cycles or when the unit shows any signs of damage or abuse. Remember that the secret to the long life of your INTERLIFT Liftgate is to maintain it through preventive care.

The **Daily Overall Inspection** should be completed by the operator each day. Perform the **Lubrication Plan** according to the following pages. The **Routine Maintenance Schedule** should be performed quarterly by an Authorized Service Center.

Your first visit to your Authorized Service Center should occur once the liftgate has been in operation for 30 days. The importance of this initial inspection is to make sure that everything is working properly during the break in period. Once this is complete, return quarterly to your Authorized Service Center.

WARNING

Do not operate the liftgate if any issues or damages are noticed during its daily inspection. Liftgate malfunction may cause severe personal injury or death. Liftgate should be inspected IMMEDIATELY by an Authorized Service Center.

* Recommended bases for inspection and maintenance	Depending on use	Daily	Monthly	Quarterly
cleaning	x			
general lubrication of pins and bushings				x
oil level inspection			x	
oil change	x(yearly)			
check hydraulic hoses and pipes for leaks		x		
check controls and connections				x
check pins and pin retaining bolts			x	
check batteries and connections				x
check all labels for visibility		x		
visual check for loose or missing parts and un-usual noise during operation		x		
check lock bolts for tightness				x
check complete function of gate		x		
check support chains			x	
check all welds			x	
Check all fasteners			x	
Lubricate grease fittings			x	

8.3 Trailer to Tractor Ground Test

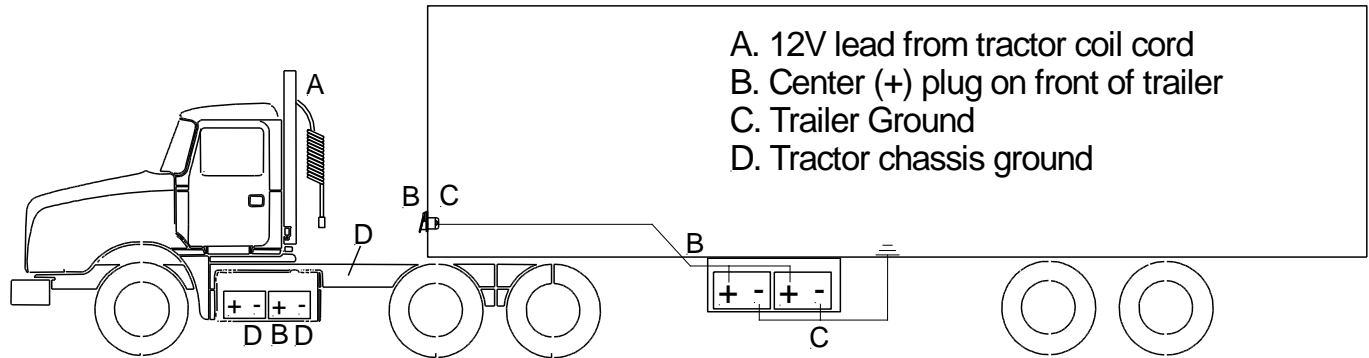

Testing of full system using a battery load tester. Start with testing each individual battery on both tractors and trailer before proceeding to check the system:

1. Tractor Test:

Ground battery load tester on tractor chassis point (D)

Connect positive load tester cable on positive pole of single pole plug at end of tractor coil cord (A)

Run load test- This will test entire circuit on tractor including ground

2. Trailer Test:

Ground battery load tester on trailer chassis point (C)

Connect positive cable on positive pole of single pole plug receptacle on trailer (B).

Run load test- This will test entire circuit on trailer including circuit breakers and ground between trailer batteries and trailer chassis.

3. Tractor and Trailer Charging system test while connected:

Ground battery load tester on tractor chassis point (D)

Connect positive cable on positive pole of single pole plug receptacle on trailer (B).

Run load test- This will test entire circuit on tractor and trailer including ground between tractor, trailer, and circuit breaker on trailer.

A simple low amp voltage test at the front of the trailer or at the tractor will not show insufficient connections or ground problems.

8.4 Lubrication

Proper lubrication will help ensure a long trouble-free service life for the INTERLIFT PTV. Therefore, the liftgate should be lubricated at the same time as the truck/trailer. Grease more frequently if the lift gate is heavily used or whenever the pivot points appear to be dry. Average PTV use is considered 25 cycles per day or 500 cycles per month. Lubricate the gate at least every 3 months or 1500 cycles, whichever comes first.

CAUTION

DO NOT grease the “Slide Bearings” or “Columns” or “Runners”, as this will **VOID** your **WARRANTY** on the slide bearings.

- Liftgates with Fixed Ramps have 9 grease fittings.
- Liftgates with Aluminum Retention Ramps (ARR) have 11 grease fittings.

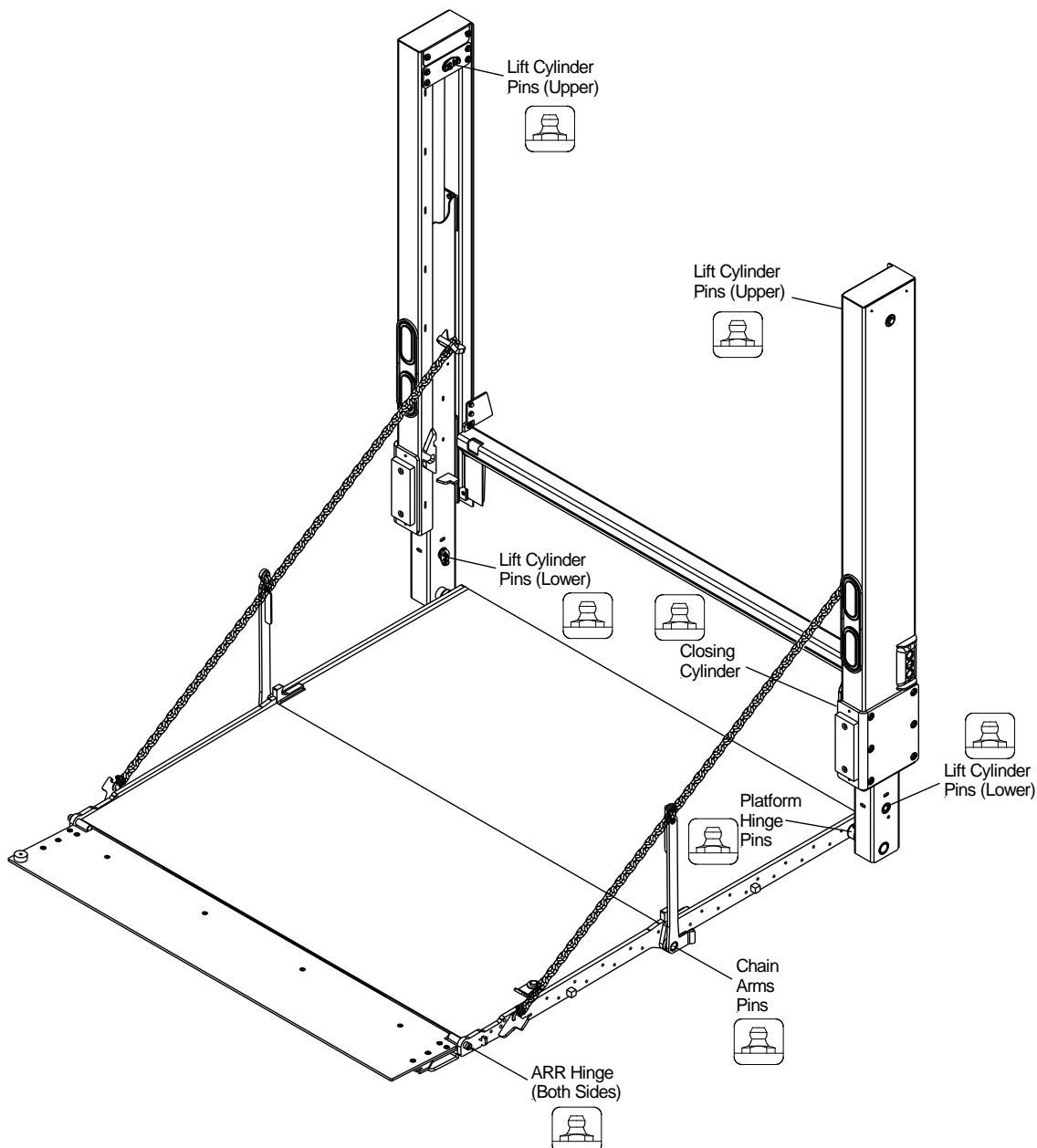

8.5 Checking and Changing the Oil

1. Remove the hydraulic enclosure cover.
2. Check Oil quality. If bad, follow next steps.
3. Open the platform to bed level. Remove the Oil Filler Cap.
4. Use a pump to remove the old oil. Catch the fluid in an adequate container. DO NOT disconnect any hydraulic hoses. Responsibly dispose of the old hydraulic fluid.
5. Fill up the Oil Reservoir with approved oil and secure the Oil Reservoir Cap. Maintain the fluid level to the indicated marking on the Oil Level Decal. See next page for recommended oil.
6. Operate the gate through 3 cycles to disperse the oil.
7. Reinstall the oil filler cap and the hydraulic enclosure cover.

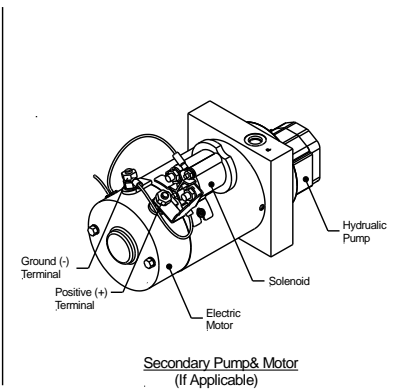
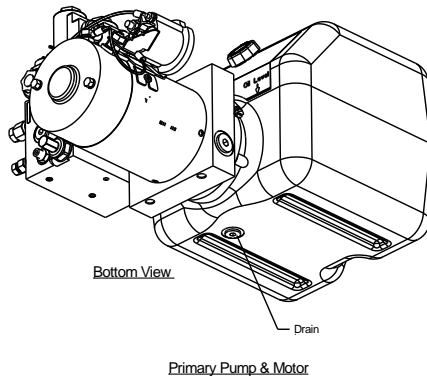
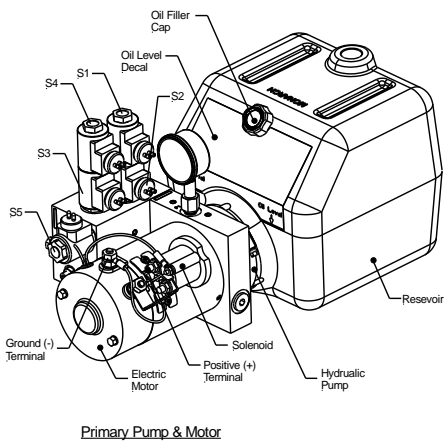

All PTV liftgates come with Hydrex MV Arctic 15 hydraulic fluid.

Hydraulic Fluid Installed from Factory	
Property	HYDREX MV ARCTIC 15
<i>Start Up Temperature</i>	<50°C / -58°F
<i>Operating Temperature</i>	-45°C to +23°C / -49°F to 73°F
<i>Pour Point</i>	-57°C / -71°F
<i>Flash Point</i>	128°C / 262°F
<i>Density 15°C (59°F). kg/L</i>	0.834
<i>Viscosity:</i> <i>cSt @ 40°C/SUV @ 100°F</i> <i>cSt @ 100°C/SUV @ 210°F</i> <i>cP @ -50°C (-58°F)</i>	13.0 / 69.7 4.95 / 42.5 1,310

When changing fluids, it is highly recommended to use Hydrex MV Arctic 15 fluid, however, the alternatives fluid brands listed below can be used.

Alternative Fluids	
Temperature Range	Fluid Brand
30° TO 150°F	EXXON UNIVIS J26
	MOBIL DTE 13M
	CHEVRON AW MV32
	ROSEMEAD MV 150 (32)
-50° TO 150°	MOBILE DTE 11
	SHELL AERO FLUID 4/41
	SHELL TELLUS 15
Extreme Cold Temperature	MIL H5606 (Military Spec.)

8.6 Decal Placement and Inspection

! For operator's safety, all decals appearing in "Decal Kit" must be placed visibly on control side of liftgate to be read by operator. This is typically a combination of decals on the liftgate and truck body. Please make sure to place the maximum capacity decal (D) on driver and curb side.

Decals			
Decal	Qty.	Part No.	Description
A	1	ML85-1121-005	Operating Instructions - PTV
AA	1	ML85-1121-007	Operating Instructions – PTV-BG
B	1	MLATG-URGWA	Urgent Warning: Elevating Gate Instructions
C	1	MLATG-OPENILD	Notice for Open & Close
D	2	MLATG-XXXX	Max. Capacity (please check the serial number plate to find out your specific capacity)
E	2	MLATG-WLH	Warning: Liftgate Can Crush
F	1	ML85-1121-004	Main Operation Switch - PTV
FF	1	ML85-1121-006	Main Operation Switch – PTV-BG
G	2	MLATG-PLAT	Warning: Always Stand Clear of Platform Area
H	1	MLATG-UD	Toggle Decal: Up-Down
J	1	MLATG-BKR	Circuit Breaker Reset (Must be located at the circuit breaker)
K	1	MLATG-RESET	Circuit Breaker Protection
L	1	ML85-1114-003/ML85-1114-001	Conspicuity Tape (If applicable)
M	1	MLATG-ARWILD	Arrow Decal
N	2	OS1263362	Palfinger Nameplate (Vertical)
O	1	ML85-1117-000	M-Board Fault Codes, Pump and Motor Enclosure Lid
P	1	ML85-1117-003	3-Button Auxiliary Hand Control, Pump and Motor Enclosure
Q	1	ML85-1121-010	Electrical Schematic, Pump and Motor Enclosure Lid

The image displays a variety of decals for the liftgate system, organized by their corresponding part numbers from the table above:

- A:** Operating Instructions - PTV (2 PC Folding Platforms)
- AA:** Operating Instructions - PTV-BG
- B:** Urgent Warning: Elevating Gate Instructions
- C:** Notice for Open & Close
- D:** Maximum Capacity Decal (XXXX LBS / XXXX KG)
- E:** Warning: Liftgate Can Crush
- F:** Main Operation Switch - PTV
- FF:** Main Operation Switch - PTV-BG
- G:** Warning: Always Stand Clear of Platform Area
- H:** Toggle Decal: Up-Down
- J:** Circuit Breaker Reset
- K:** Circuit Breaker Protection
- L:** Conspicuity Tape
- M:** Arrow Decal (Align Arrows to Open & Close Platform)
- N:** Palfinger Nameplate (Vertical)
- O:** M-Board Fault Codes
- P:** 3-Button Auxiliary Hand Control
- Q:** Electrical Schematic

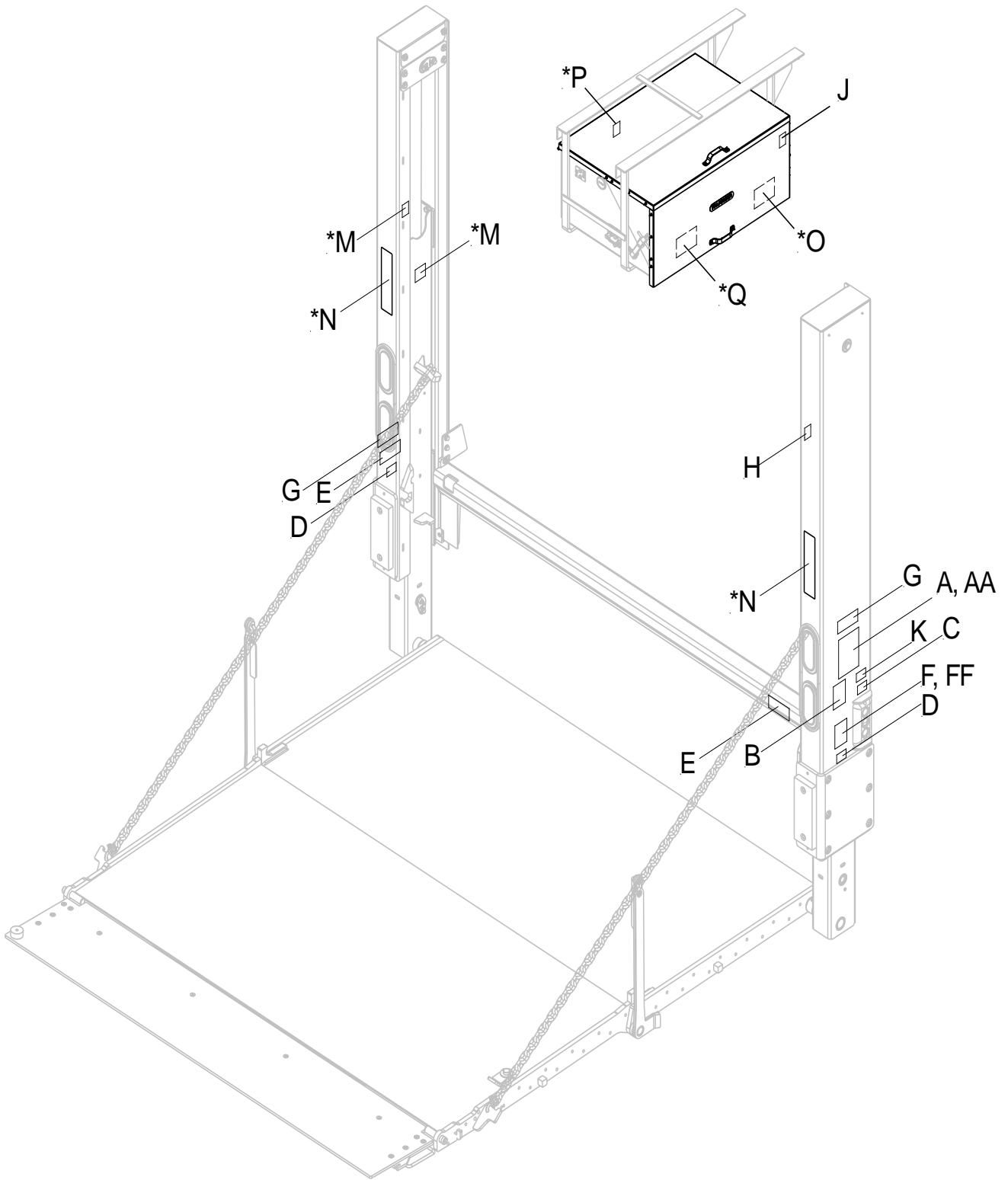

**Pre-installed decals*

NOTICE

It is the installer's responsibility to determine the proper application of the Conspicuity tape, and to ensure that the vehicle or trailer meets DOT and federal lighting regulations. The following diagram is a guideline for placement on trailers over 80" wide and GVWR of 10,000 Lbs. or more. This document is not intended to replace published agency regulations, and it is strongly recommended that the installer refer to the Code of Federal Regulations (CFR) which can be viewed at <http://ECFR.gpoaccess.gov>.

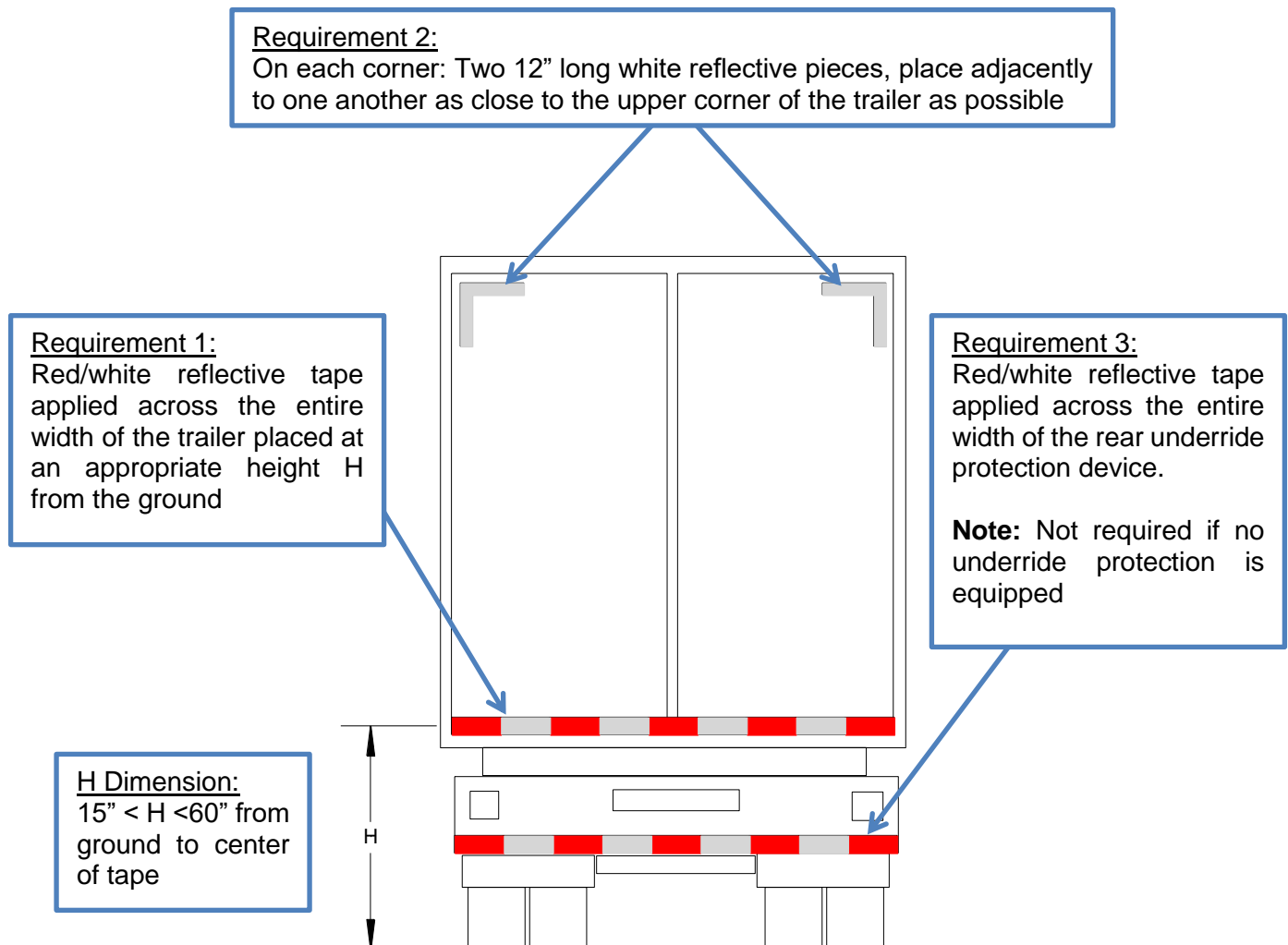

9 Troubleshooting

⚠ WARNING

Dangerous injuries are possible from objects such as tools short circuiting main battery connections. Be sure that you are working in a safe environment.

NOTICE

Change oil after working on hydraulic unit (removal of valves, opening of cylinder etc.). There is a possibility of injury if somebody other than an authorized technician works on the electrical system!

9.1 Basic Function Check

9.1.1 Liftgate is completely Dead (No Clicking or Movement at all)

1. Check the cab shut off switch:

Turn on cab switch, located in the cab next to the steering wheel. Location may vary by model and year of truck. On trailer units, you will find a toggle switch near rear curb side corner post to activate the gate.

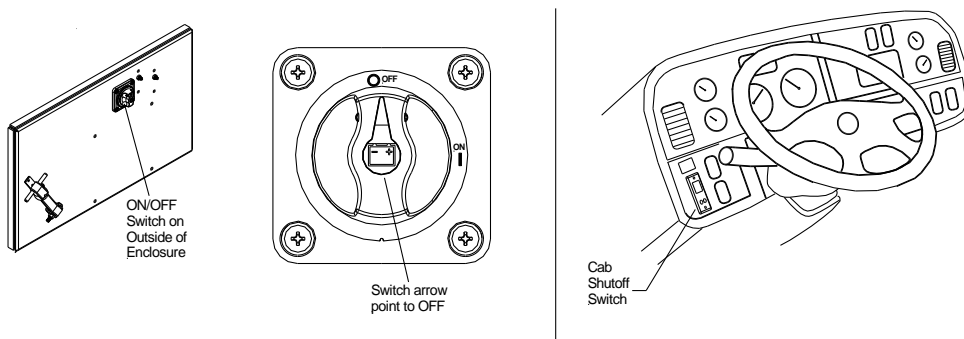

2. Check the circuit breaker at the main batteries:

Every truck has a circuit breaker on top of the main battery. Trailers and some trucks are equipped with an auxiliary battery kit as shown in the pictures below (“Truck Battery” and “Auxiliary Battery”).

If circuit breaker reset arm is popped out, push it back in as shown on the decal ATG-BKR next to your breaker or on battery box lid.

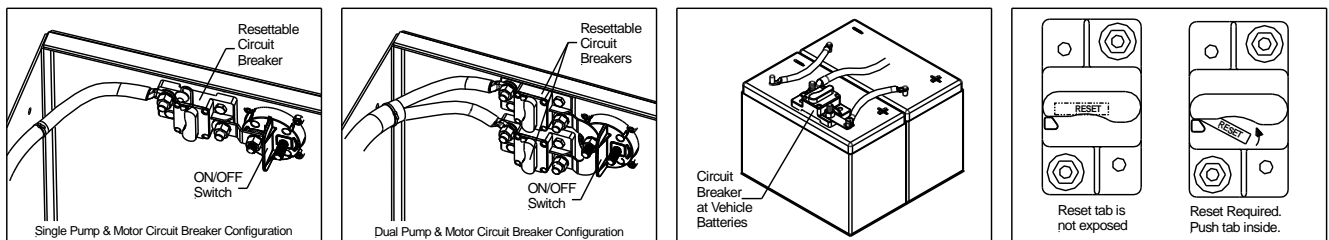

3. Are the vehicle batteries charged?

Check batteries and the truck/trailer charging system. Start truck and run engine in fast idle for charging the batteries. If the liftgate starts working, recharge batteries.

4. Check the fuse at the power pack.

Remove the Housing Cover. After opening the Cover, you will see the fuse in front of the Power Pack, as shown in the following picture. If the fuse is blown replace with the same type.



DO NOT use higher amperage fuse.

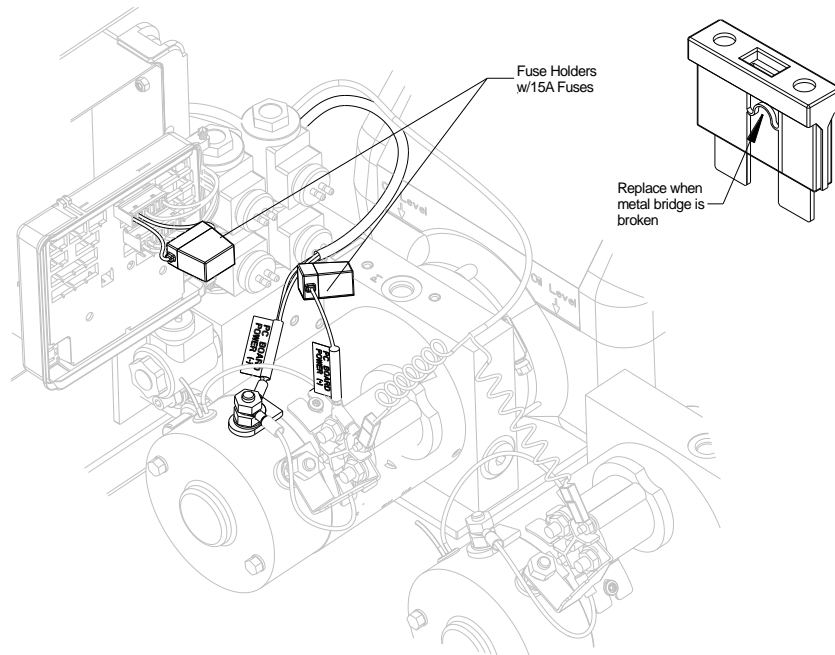

5. Is the connection to the ground in the power pack OK?

Is the ground connection from the liftgate to vehicle OK?

6. Check the oil level in the power pack reservoir.

7. Are there any damages to mechanical or electrical parts (such as damaged cables, hoses, etc.)?

9.2 Battery Wiring – Truck Kit

For 24V wiring reference document 90-1120-005.

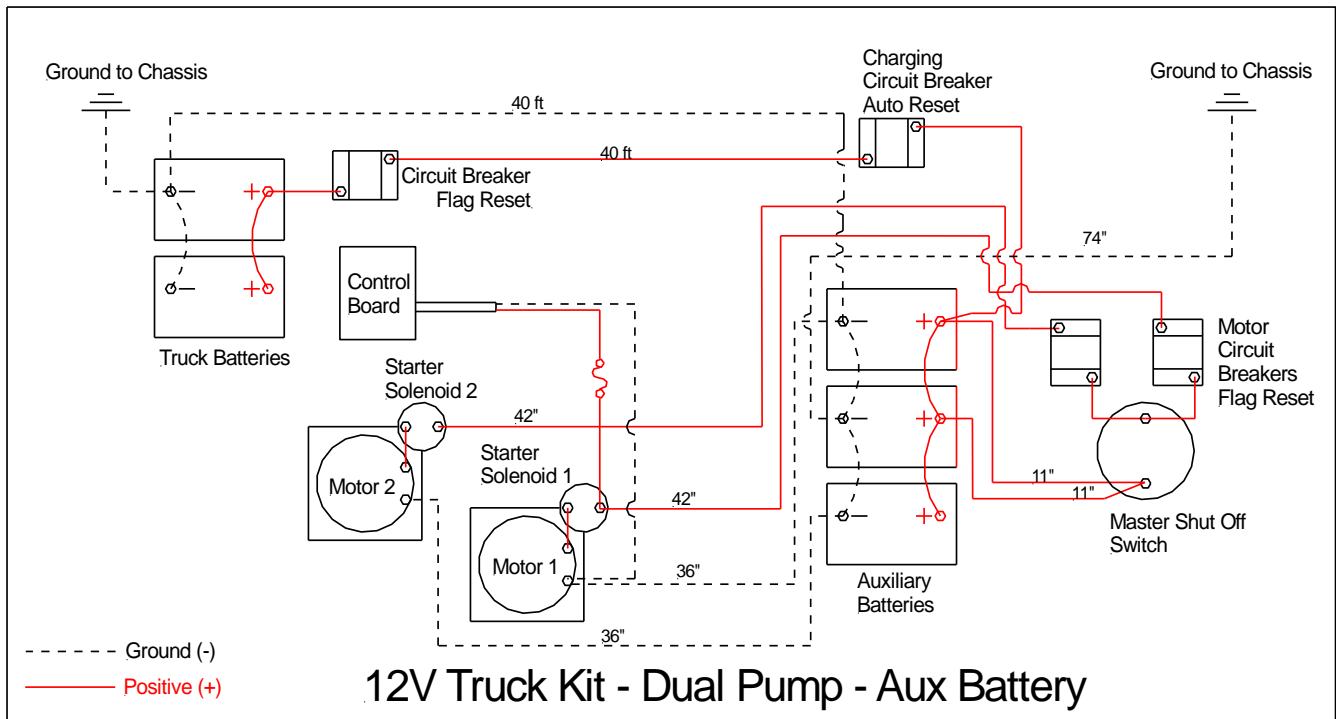
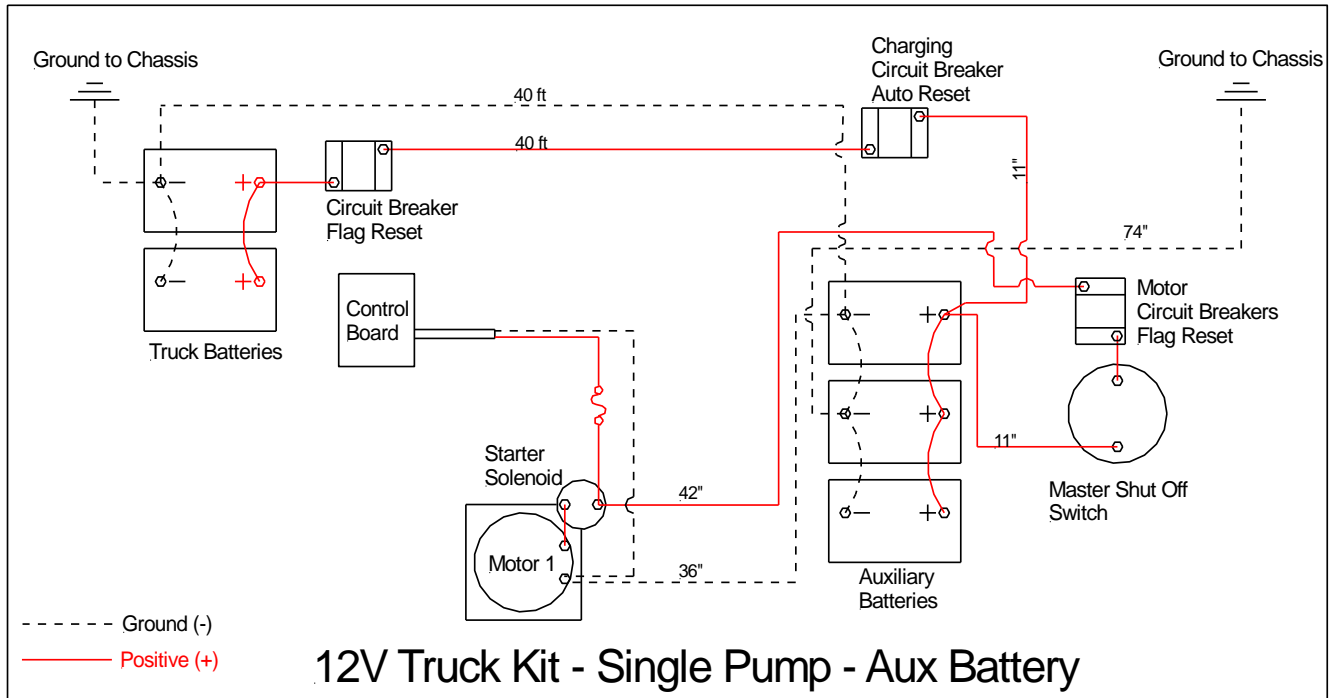

9.4 Battery Wiring – Trailer Kit

For 24V wiring reference document 90-1117-008.

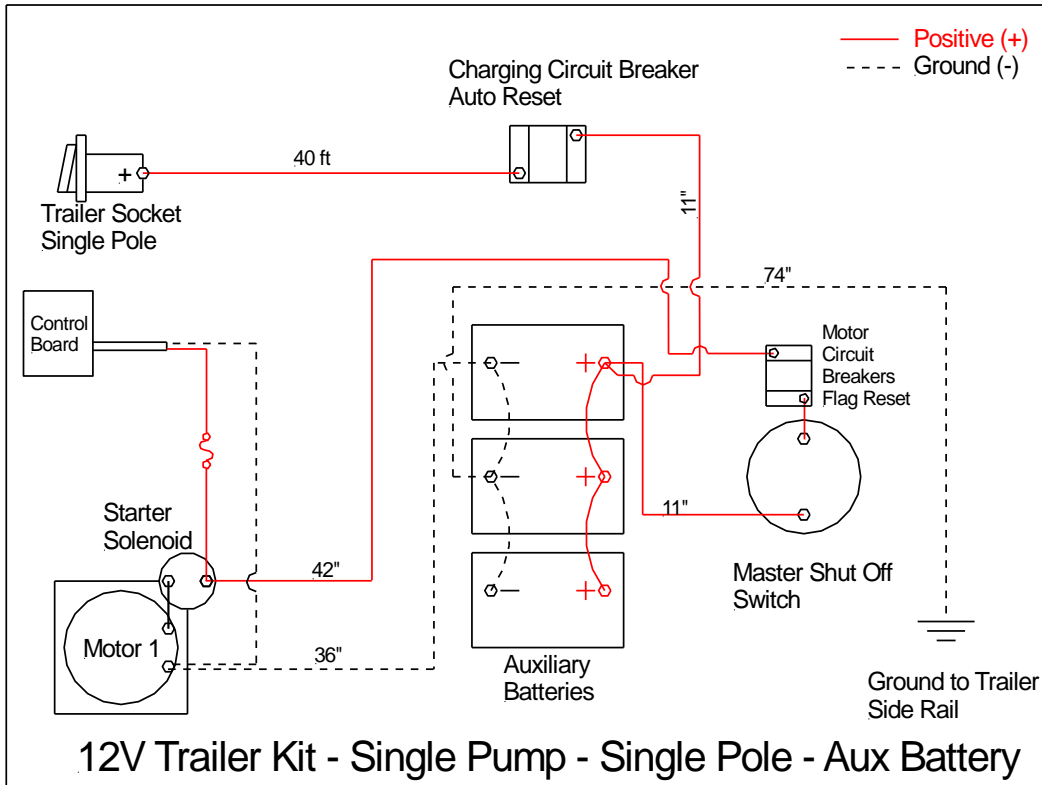

12V Trailer Kit - Single Pump - Single Pole - Aux Battery

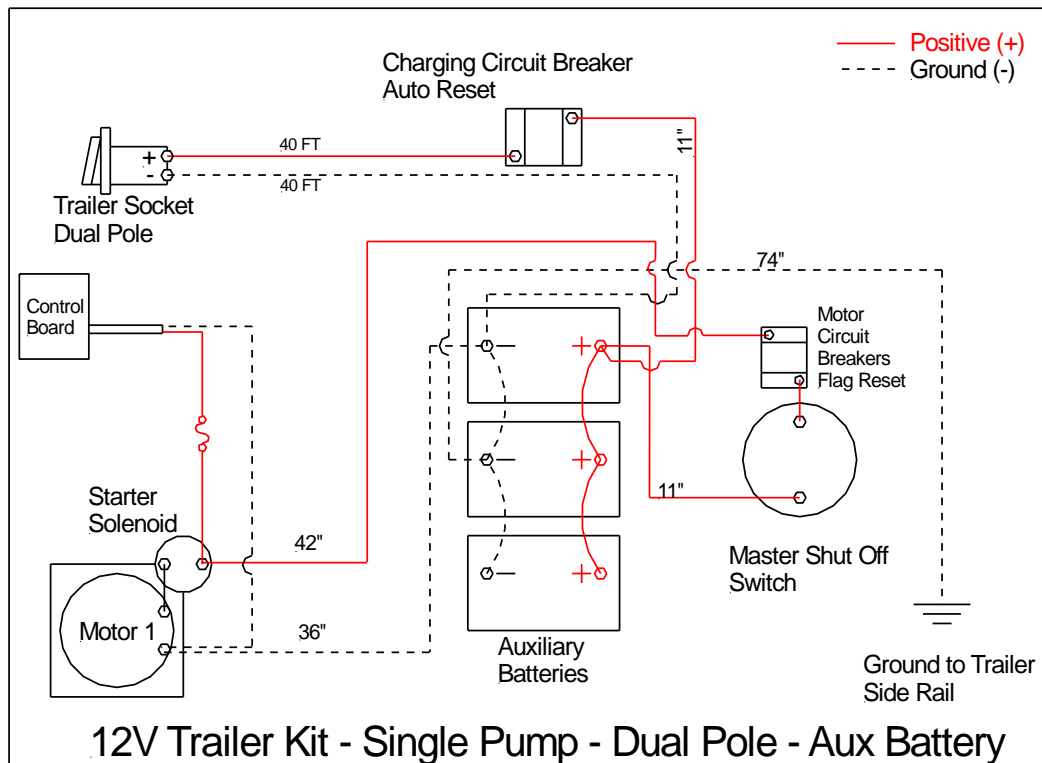

12V Trailer Kit - Single Pump - Dual Pole - Aux Battery

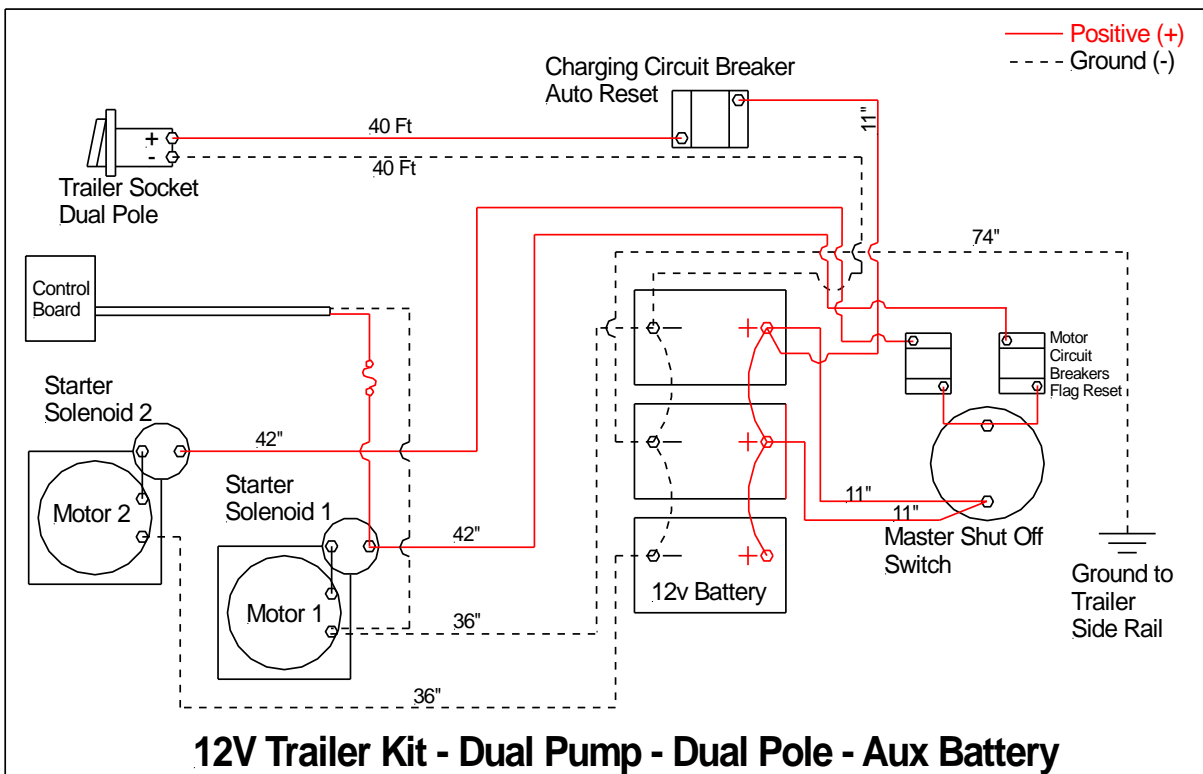
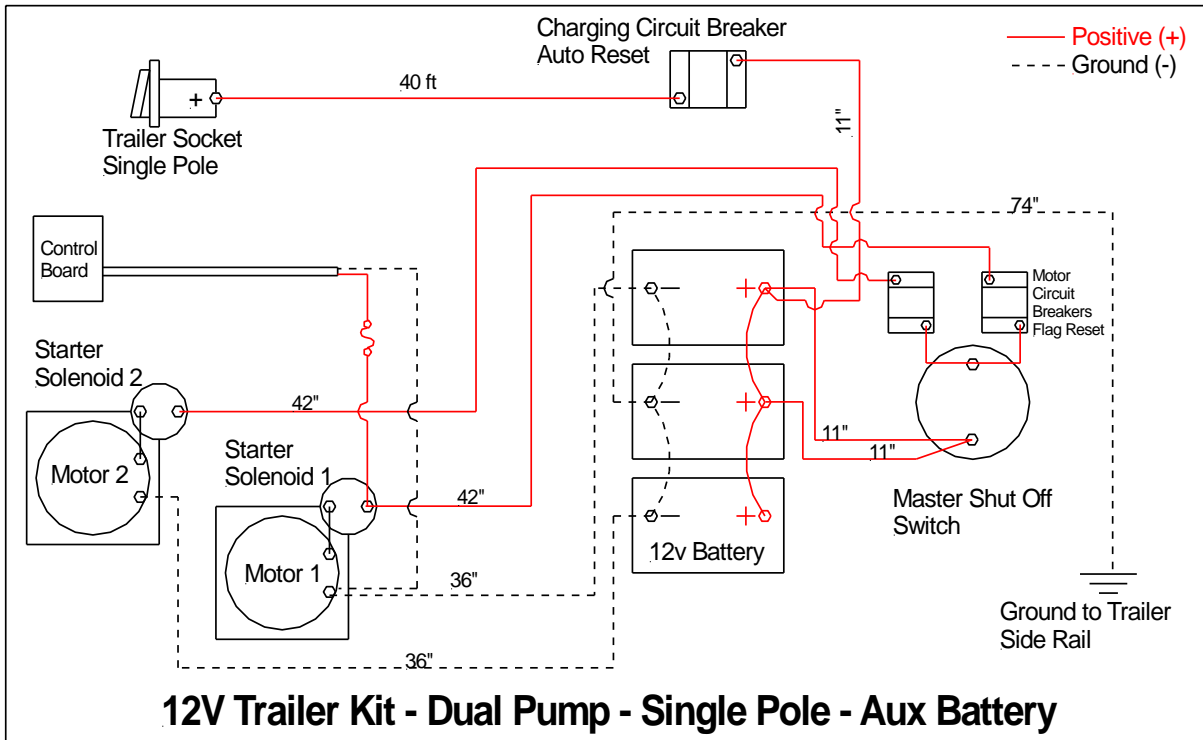

9.5 Electrical Schematic Overview

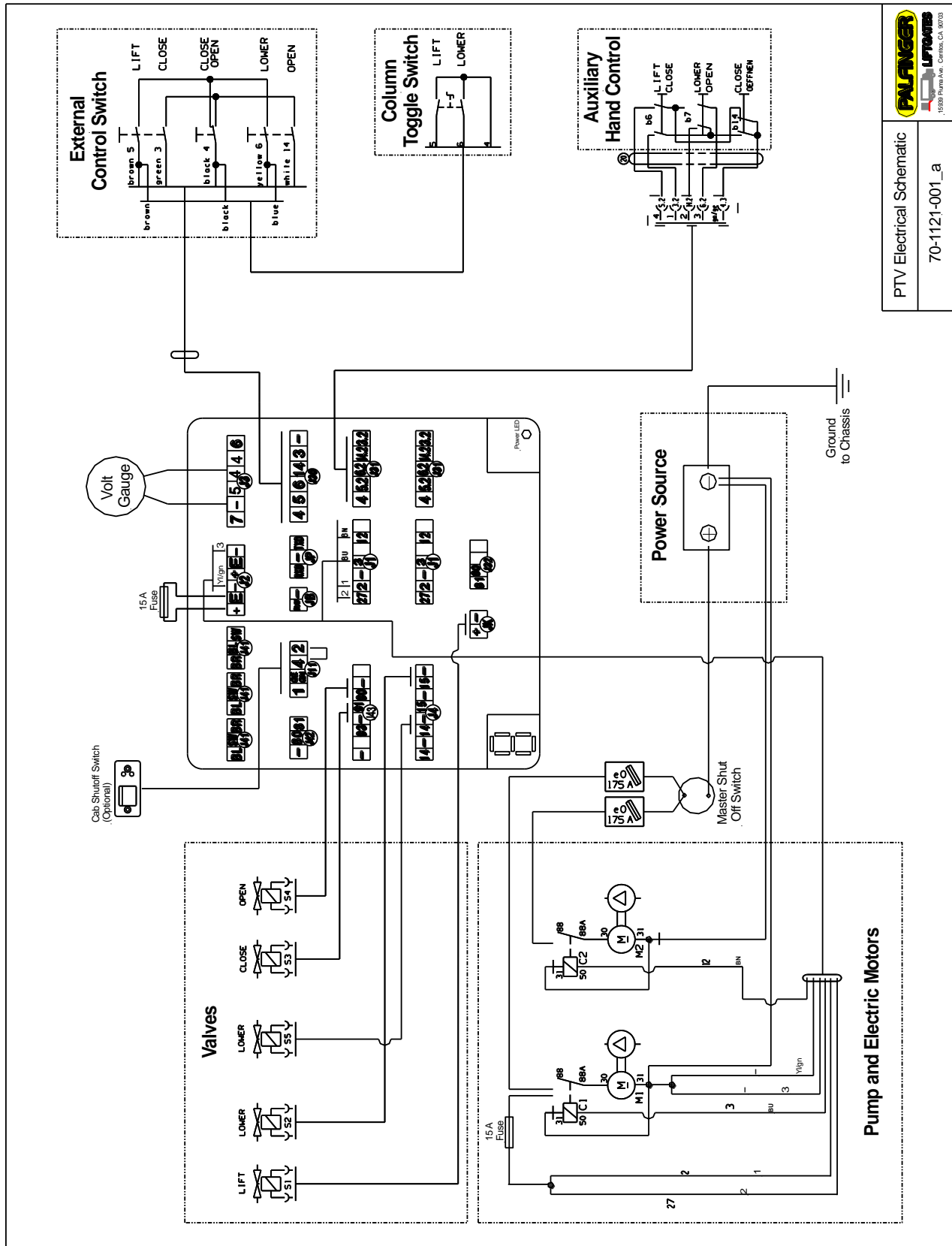

FALINGER
LIFT TRUCKS
15839 Purina Ave. Centex, CA 90703

PTV Electrical Schematic
70-1121-001_a

9.6 Control Board Codes

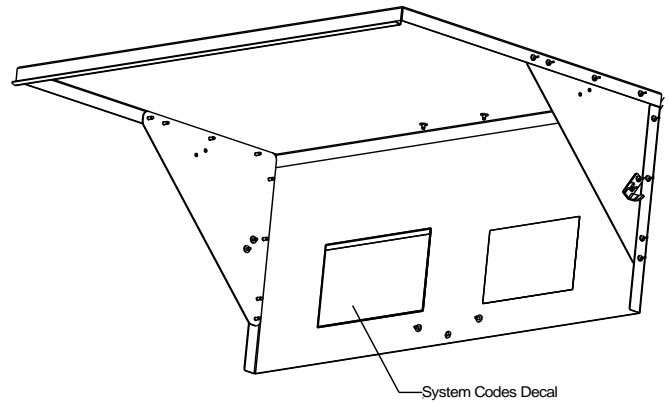
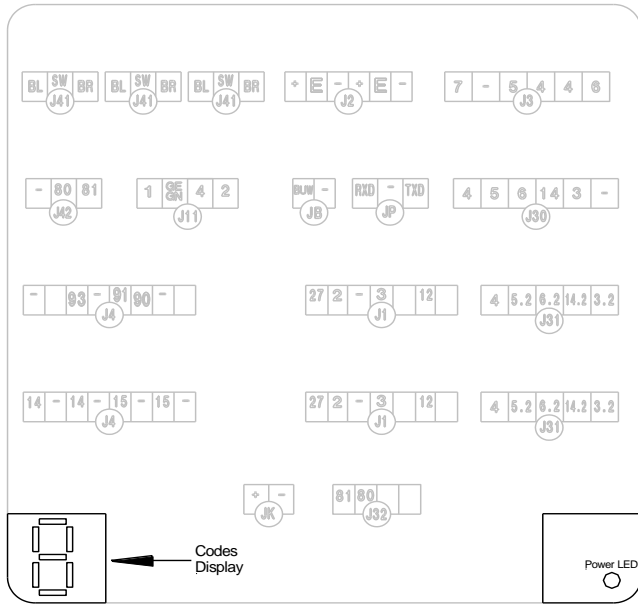



Inside View of Pump and Motor Enclosure Lid

Control Board Code	Description	Reset
0	System ok / Cab switch off, (or missing bridge J11/2<->4)	
1	System ok / Cab switch on, (or bridge J11/2<->4)	
2	Low voltage – start truck engine, charge battery	Cab switch: off/on (or disconnect bridge J11/2<->4)
7	Short in cab switch / on-off-switch or aux port	Cab switch: off/on (or disconnect bridge J11/2<->4) or close tail lift
8	General short in electric wiring	Cab switch: off/on (or disconnect bridge J11/2<->4) or voltage interruption MBB control
9	Defect at motor solenoid detected during lifting	Automatically when the valves are back to normal
A	Voltage V02 (J1 pin 2) is missing, defective fuse?	Replace the fuse
b	Defect at opening, valve (S3/S4) or motor relay detected during opening	Automatically when the valves are back to normal
c	Defect at motor solenoid or S5 valve detected during closing	Automatically when the valves are back to normal
P	Diagnosis mode activated	Removing service connector
To clear code: Unplug J11 and plug back in.		

9.7 Hydraulic Schematic

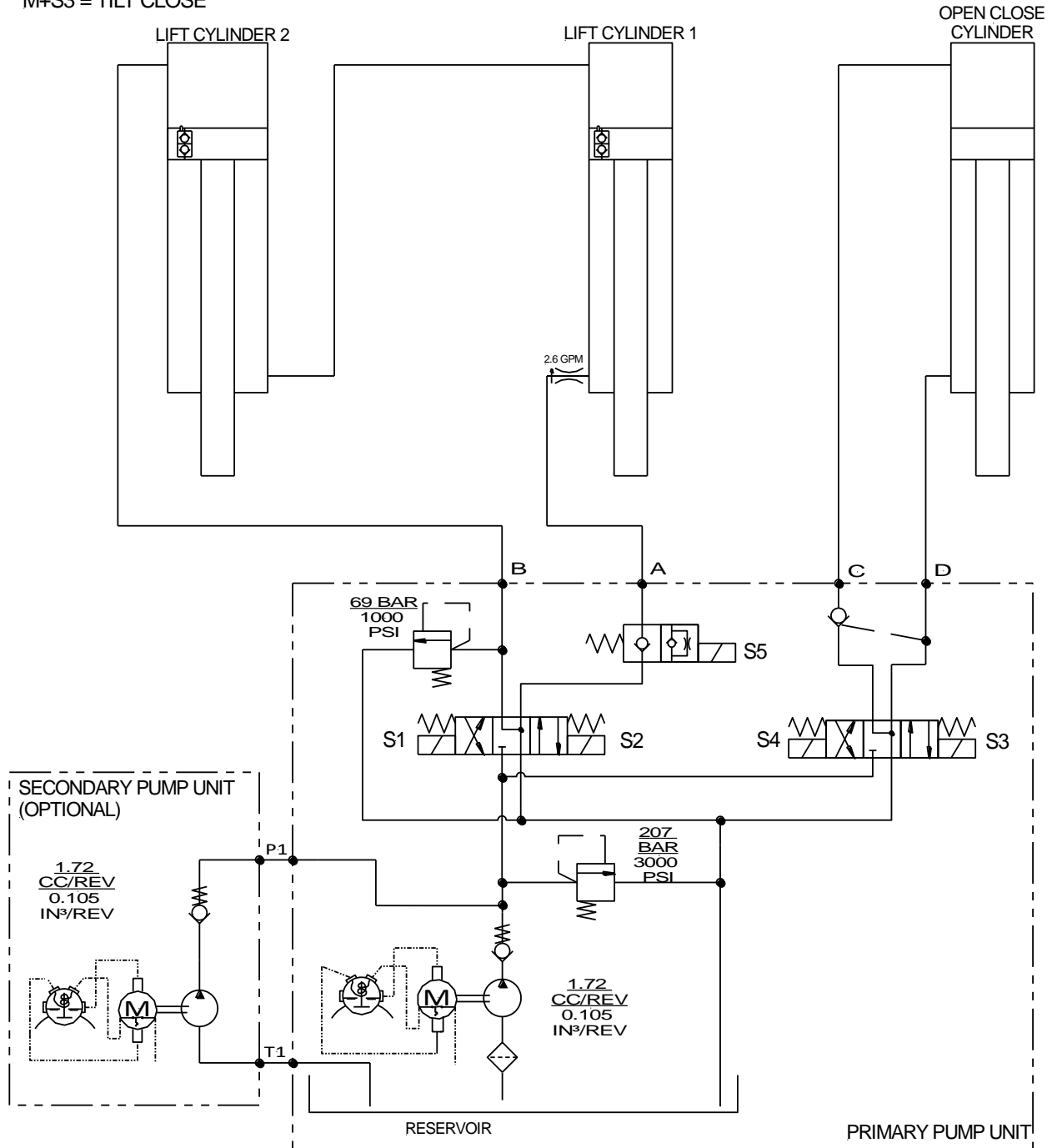
M+S1 = LIFT
 M+S2+S5 = POWER DOWN
 S5 = GRAVITY DOWN
 M+S4 = TILT OPEN
 M+S3 = TILT CLOSE



HYDRAULIC, SCHEMATIC, PTV BUCHER PUMP (90-1118-001)	  15939 Pluma Ave. Cerritos, CA 90703
--	---

10 **Required Information for Ordering Spare Parts and Repairs**

10.1 **Ordering Spare/Replacement Parts**

In order to assure quick delivery of replacement parts, always state the following information when making orders:

1. Liftgate model & serial number.
2. Designation and number of the spare part in accordance with the proper spare parts list.
3. Designation and number marked on the individual component (if available).

10.2 **Repairs**

Parts sent to INTERLIFT Liftgates to repair must be accompanied by a letter (in separate cover) giving details and scope of the repairs required.

11 Warranty

INTERLIFT Liftgates provides warranty as part of its conditions of delivery.

All part deliveries will initially be billed. INTERLIFT Liftgates then issues credit for all or part of the invoiced sum, when INTERLIFT Liftgates has been able to determine that the warranty claim is justified as defined by its warranty conditions. INTERLIFT Liftgates does this by inspecting the defective parts, which are sent back to INTERLIFT Liftgates freight prepaid as well as the written description of the problem which must be filled out in full.

The parts that are sent back to INTERLIFT Liftgates, marked with serial number and address, become INTERLIFT Liftgates' property if the warranty claim is accepted.

All warranty claims must be received **within 30 days** of repair or replacement. Including the following information:

1. Liftgate model.
2. Liftgate serial number.
3. Description of problem.
4. Itemized bill of repair with breakdown of number of hours to perform warranty work and labor charges per repair.
5. Parts used for repair with INTERLIFT Liftgates part number.
6. RMA#.
7. Contact at INTERLIFT Liftgates, if applicable.

Model	Pump and Motor	Cylinders	Hardware	Control System	Hydraulic
PTV	3 yr	3 yr	3 yr	3 yr	3 yr

Effective: Aug. 2010

12 Contact Address

15939 Piuma Ave
Cerritos, CA 90703
Phone: (562)-924-8218
Fax: (562)-924-8318

E-mail (parts order):
liftgateparts@palfinger.com

E-mail (technical support):
technicalapplications@palfinger.com



572 Whitehead Road
Trenton, NJ 08619
Phone: (609)-587-4200
Fax: (609)-587-4201

E-mail (parts order):
liftgateparts@palfinger.com

E-mail (technical support):
technicalapplications@palfinger.com