

REVISION HISTORY			
REV	DESCRIPTION	DATE	APPROVED
00	Issued for control	06/03/2012	
00a	Manual emergency valves	09/06/2015	Bogdan Yevchuk
00b	Wire sheave house	16/07/2015	Bogdan Yevchuk
00c	Issued for control	28/06/2016	BY

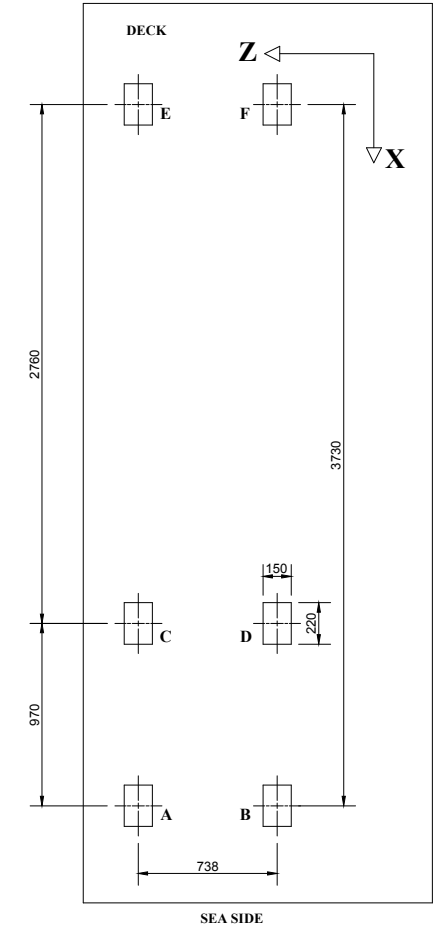

General note:
Nominal dimensions shown. Interface fittings/brackets to be spot welded prior to final welding, see installation manual for details.

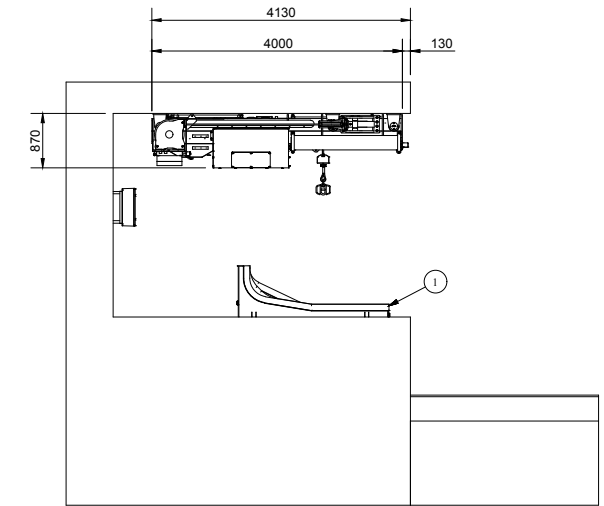
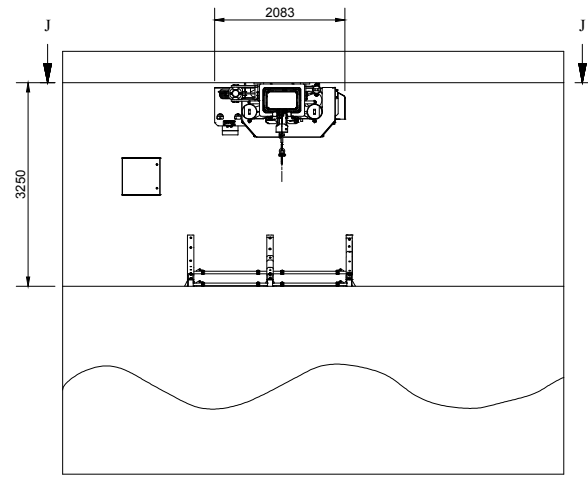
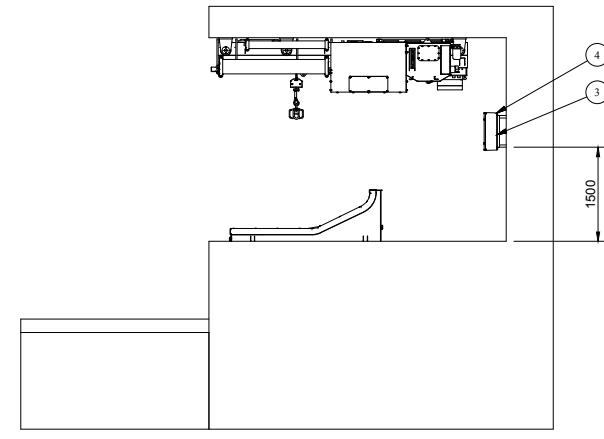
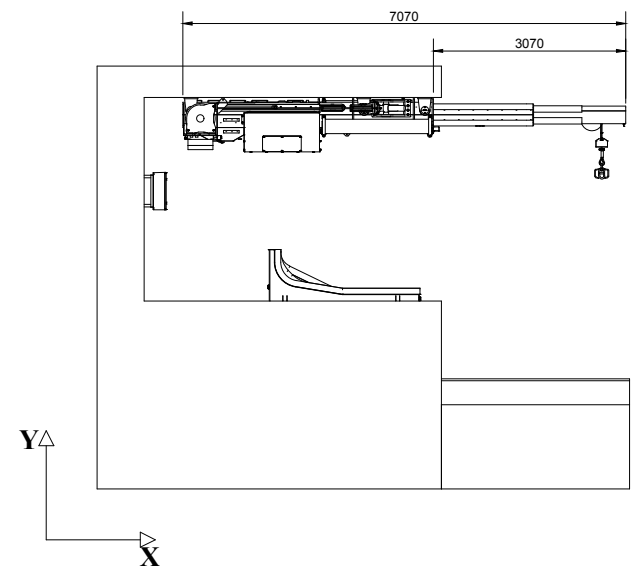
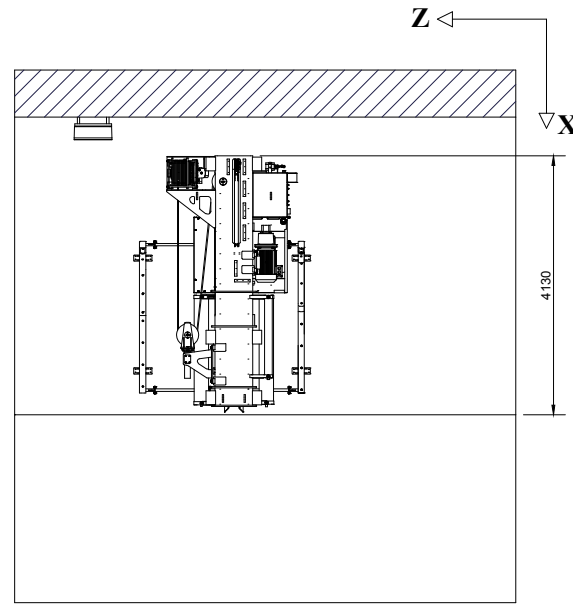
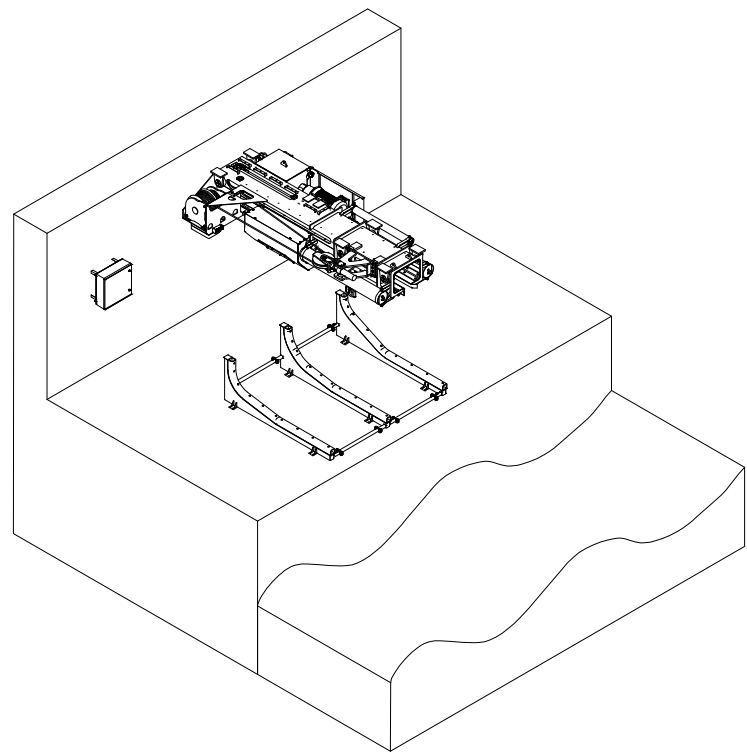

J-J (1 : 60)

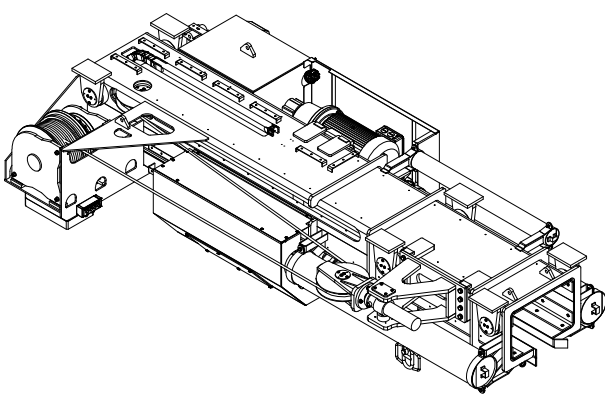

Isometric (1 : 25)

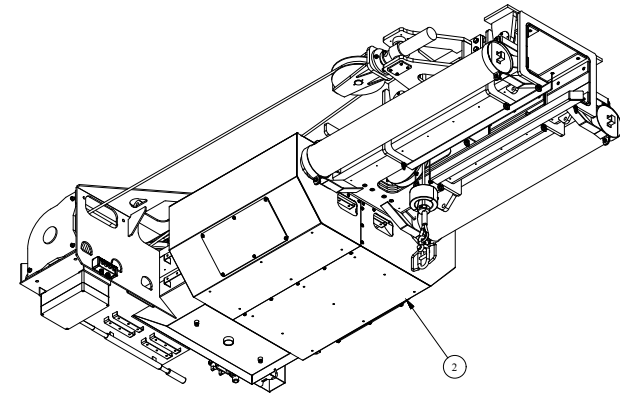

Isometric (1 : 25)

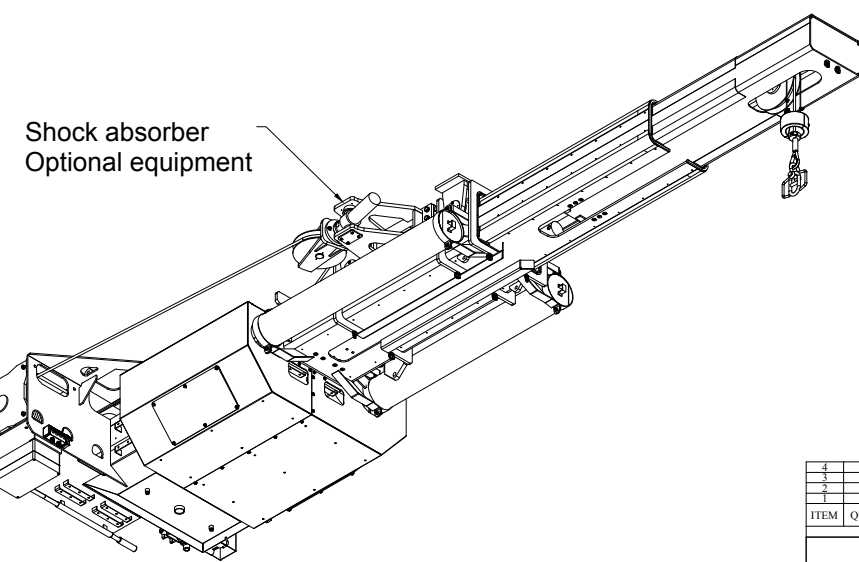

Isometric (1 : 25)

NTDS 3500H	
SWL :	3500 kg (or specified)
Hoisting/lowering speed :	18 m/min (or specified)
Dead ship lowering speed :	According to Solas requirement
Design spec. :	10 deg. trim, 20 deg. list simultaneously
Winch type :	NW 3500 (or specified)
Shock Absorber :	At request
Wave compensation :	At request
Operation :	Remote control

FORCE (kN) AND MOMENTS (kNm) ON DECK (WITHOUT SAFETY FACTOR)																		
	Ax	Ay	Az	Bx	By	Bz	Cx	Cy	Cz	Dx	Dy	Dz	Ex	Ey	Ez	Fx	Fy	Fz
FORCE (kN) ON DECK	-24,5	-69,8	0,1	-16,5	-72,5	-12,3	-13	10	-26,1	29,3	49	-27,0	-2,9	5,1	13,4	-1,6	-4,3	4,3
MOMENTS (kNm) ON DECK	-2,1	0,4	-6,1	3,1	0,3	-5,0	2,5	0,6	3,4	1,6	0,2	1,2	-1,3	-0,1	-1,5	-0,5	0,0	1,0

4	1	1900088	Electrical cabinet			
3	1	11007-50-00	Electrical cabinet support			
2	1	11007-01-00	Davit NTDS 3500H			
1	1	11007-00-100-00	Post support			
ITEM	QTY	PART NUMBER	DESCRIPTION	MATERIAL	MASS	SHEET NO
Parts List						
This drawing is our property. It can't be reproduced or communicated without our written agreement.			PALFINGER			
DRAWING TITLE : NTDS 3500H General Arrangement NTDS 3500H only davit			DRAWING NUMBER : 11007-00			
WEIGHT : N/A			MATERIAL : N/A		REV. : 00c	
DRAWN BY : ALLE			DATE : 2016-06-28		FILE NAME : 11007-00 only davit	
CHECKED BY : MW			DATE : 2016-06-28		SCALE : 1:60	
APPROVED BY : BY			DATE : 2016-06-28		SHEET SIZE : A1	
CUSTOMER :					SHEET NO. : 1/1	